

**ORIGINAL INSTRUCTIONS**

**SHIBUYA**

# **DIAMOND CORE DRILLING MACHINE OPERATOR'S INSTRUCTION MANUAL**

**WITH PARTS LISTS & DRAWINGS**

**DRILL MOTOR MODEL: H2221/H2231**

**DRILL STAND MODEL: TS-405/TS-405(AB61)**

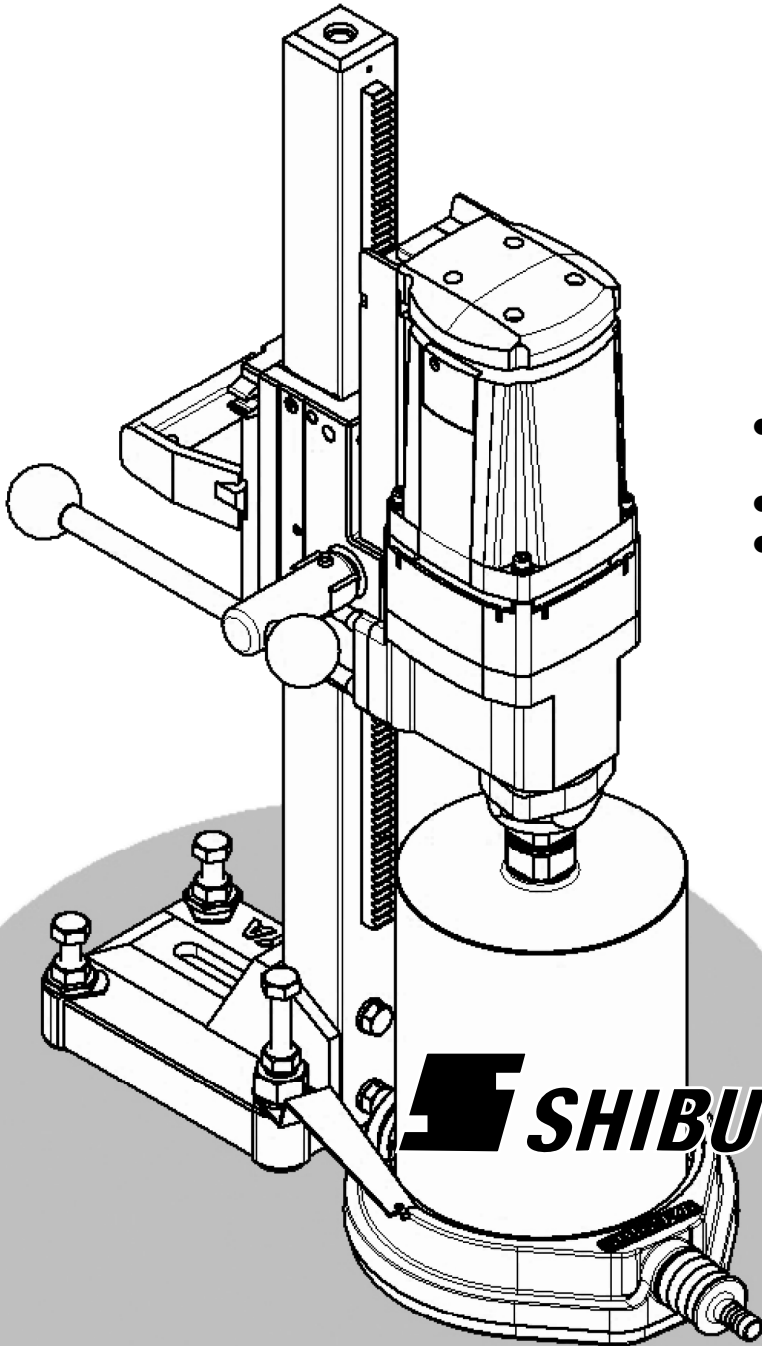

- Make sure to read and understand this manual thoroughly before starting the operation.
- Always keep this manual with the machine.
- Make sure that this manual is with the machine, when it is given and/or sold to other people.

**SHIBUYA COMPANY, LTD.**

5-86 MOKUZAIKO-KITA, HATSUKAICHI  
HIROSHIMA 738-0021  
JAPAN  
TEL: +81-829-34-4510

TS-405-H22-2024

**NAME OF EACH PART**

**H2221/H2231 Drill Motor**

1. Gear Box
2. Motor
3. Spindle
4. Grease Inlet
5. GARDENA Connector / Water Cock
6. Main Switch (Circuit Protector)
7. Swivel Ring
8. Gear Change Knob
9. Air Inlet
10. Air Outlet
11. Power Cord
12. Water Leakage Hole
13. PRCD (220-240 V model only)
14. Carriage Block
15. Stopper-Knob (Carriage Brake)
16. Quick Release Handle (Feed Handle)

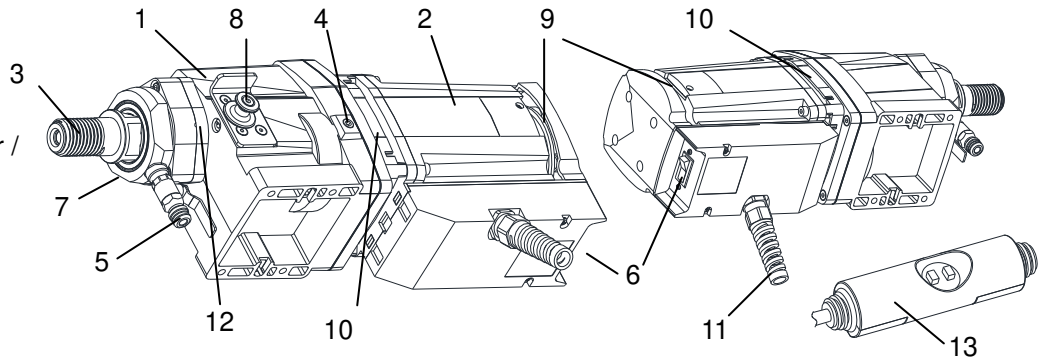

**TS-405 Drill Stand**

17. Grip Handle
18. Column
19. Anchor Slot
20. Leveling Bolt
21. Base
22. Caster

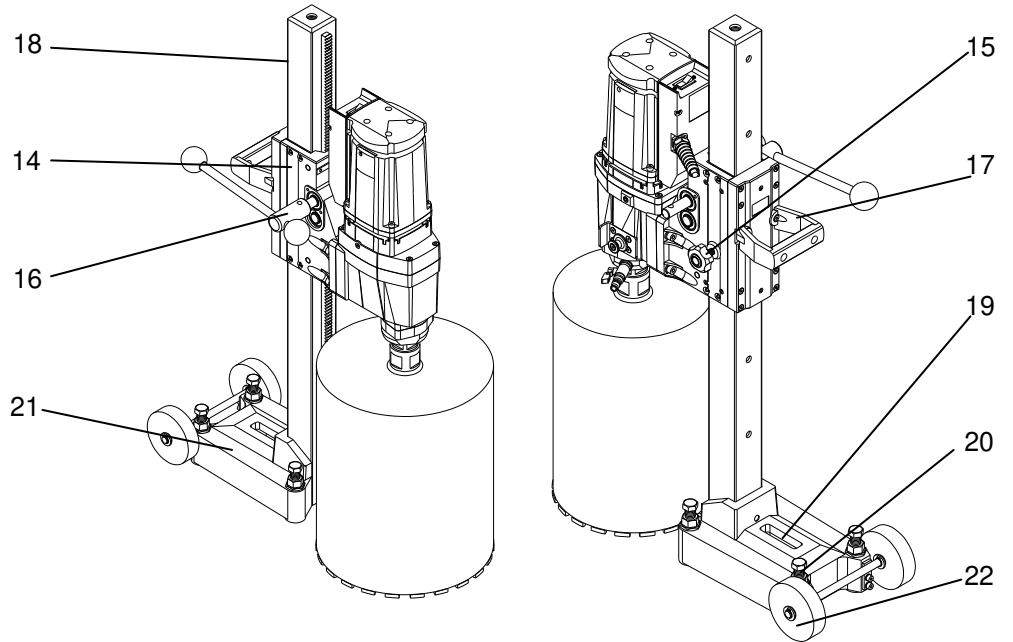

## AB61 Swivel Base (Option)

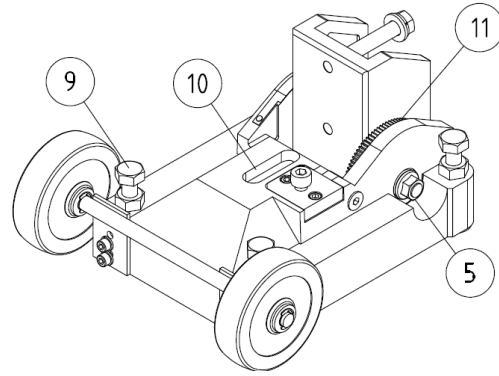
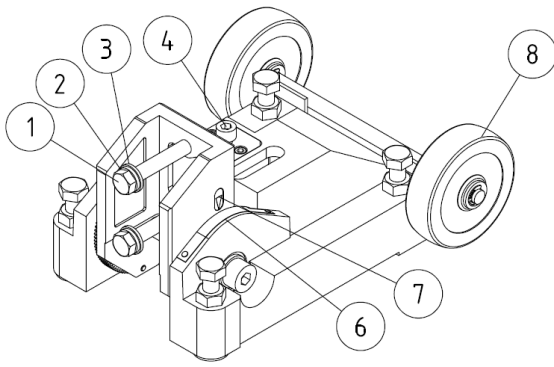

- |                      |                     |
|----------------------|---------------------|
| 1. M12 Bolt          | 7. Indication label |
| 2. M12 Spring Washer | 8. Caster           |
| 3. M12 Plain Washer  | 9. Leveling Bolt    |
| 4. M10x30 Bolt       | 10. Anchor Slot     |
| 5. M12 Nut           | 11. Gear            |
| 6. Angle Scale       |                     |

Refer to the schematic drawings and parts lists attached at the end of this manual for names of more specific parts.

## ILLUSTRATIONS OF OPERATION

(The numbers in the figure correspond to the same heading number in the writing sections.)

7.1

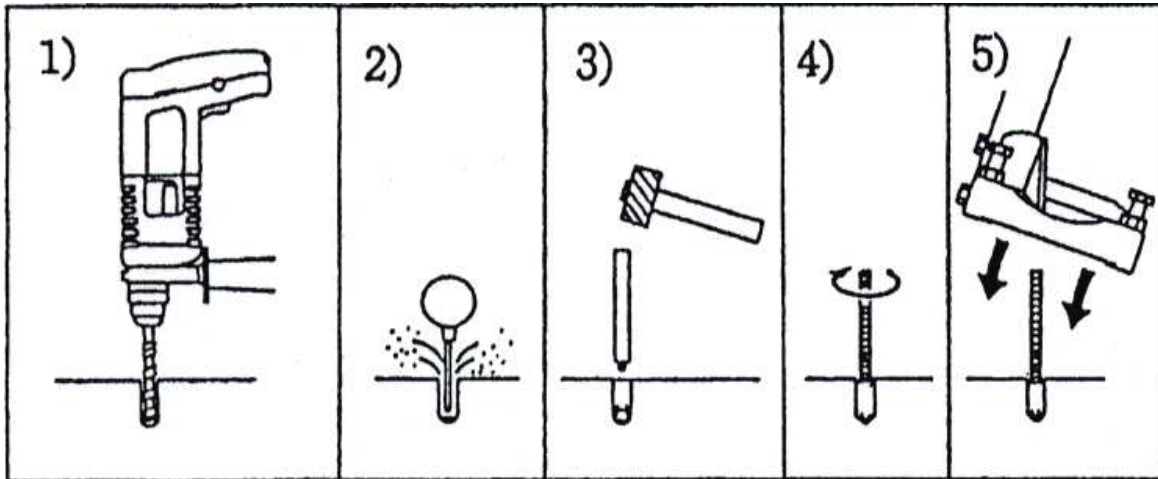

7.1

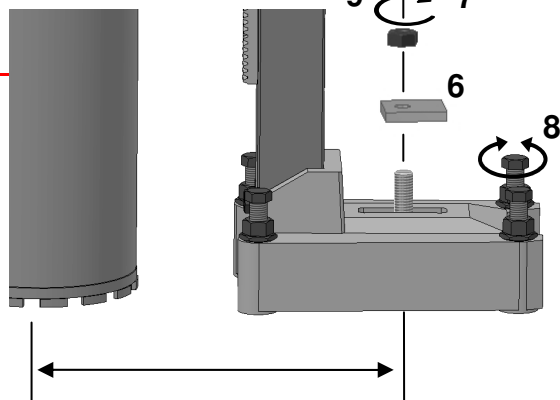

With 30 mm spacer: 328-338 mm (13-15")  
 Without 30 mm spacer: 298-358 mm (12-14")

7.1

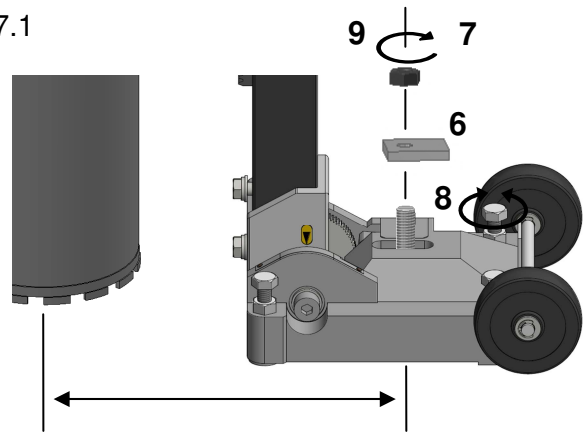

With 30 mm spacer: 352-395 mm (14-15")  
 Without 30 mm spacer: 322-365 mm (13-14")

7.3.1

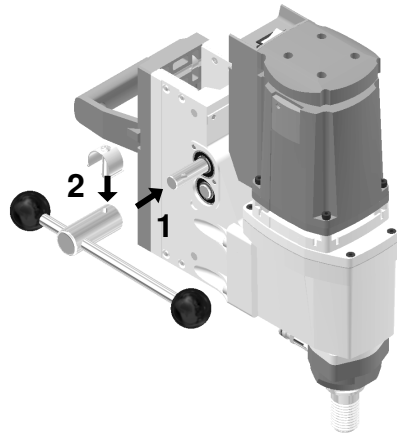

7.3.2

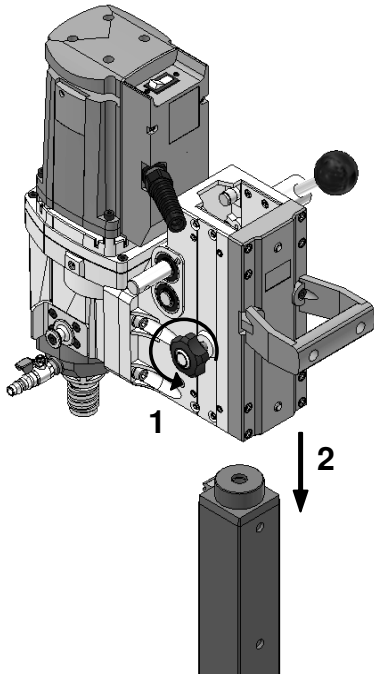

7.3.2

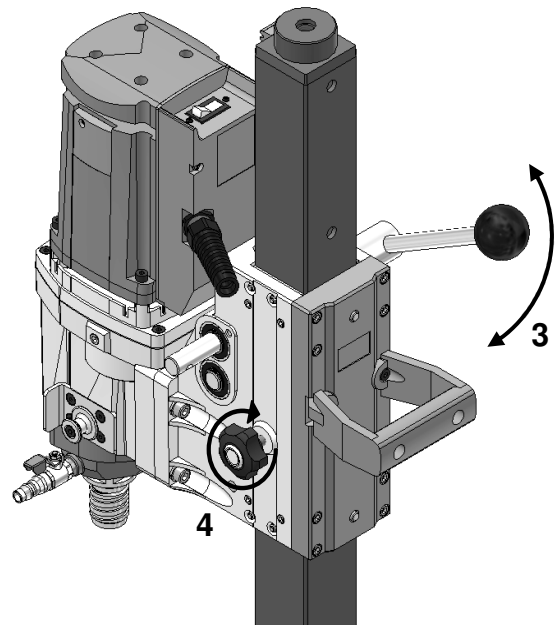

7.3.3

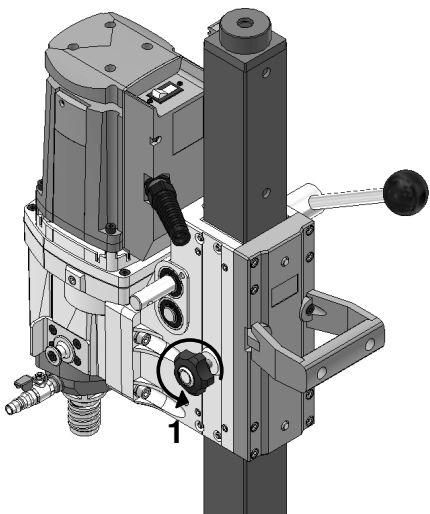

7.3.3

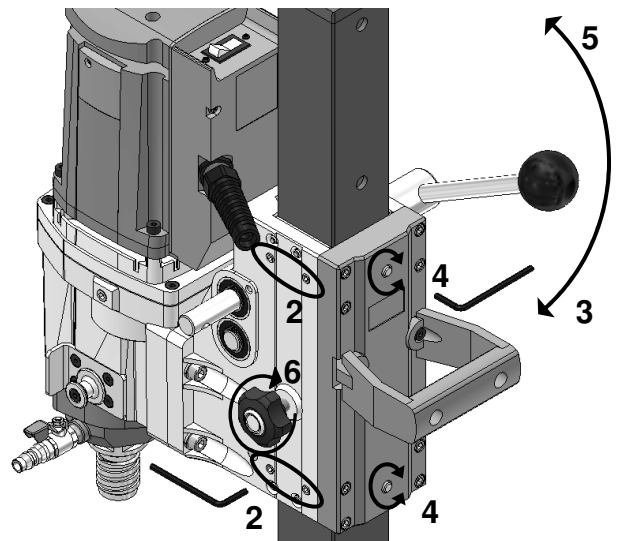

7.4

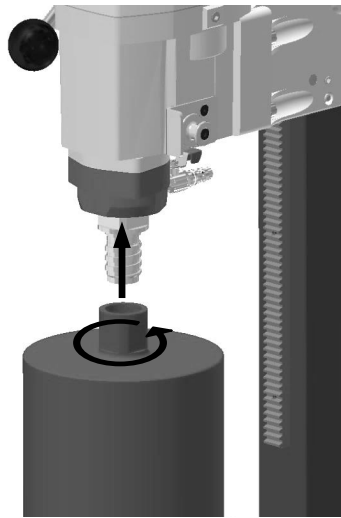

7.6

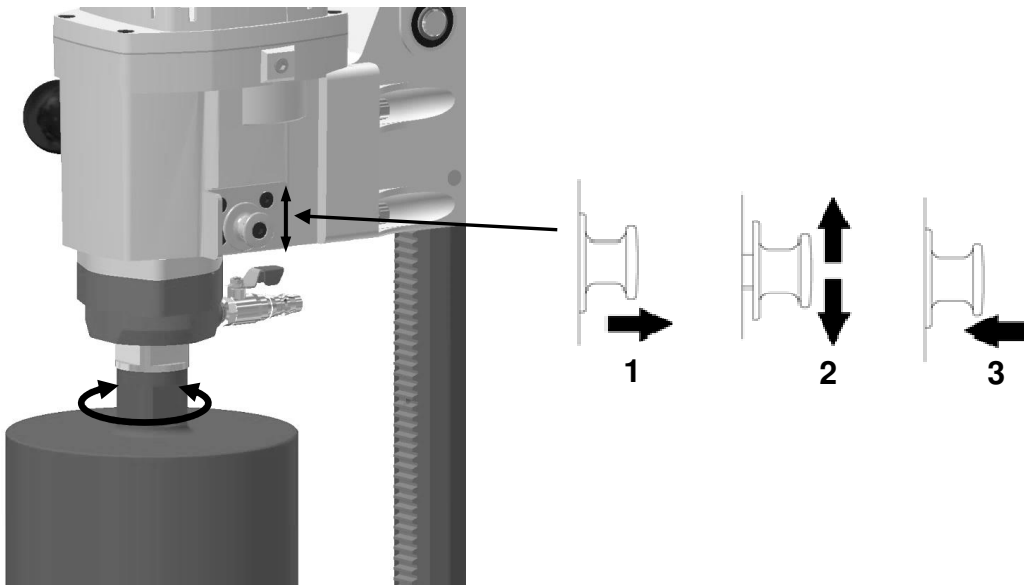

7.7

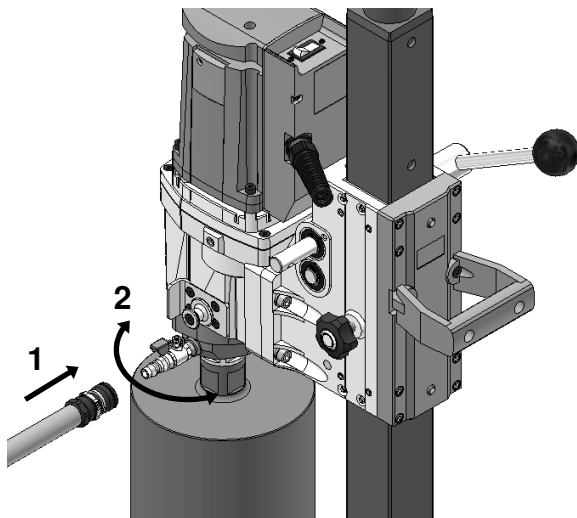

8.2.1

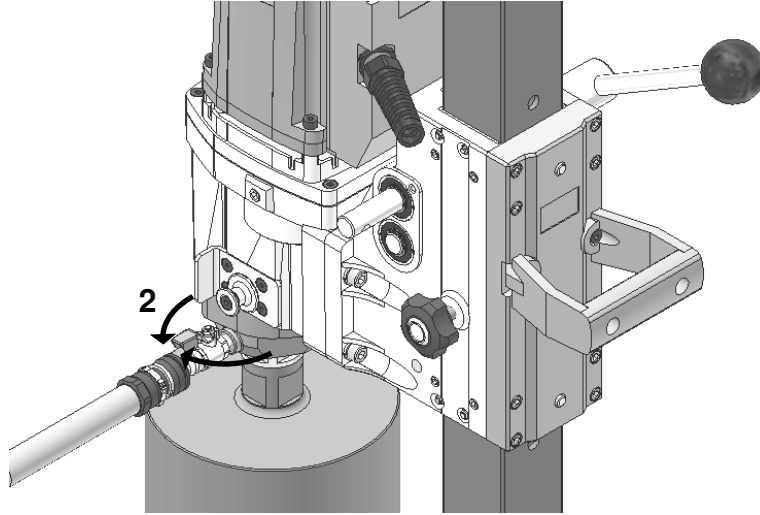

8.2.1

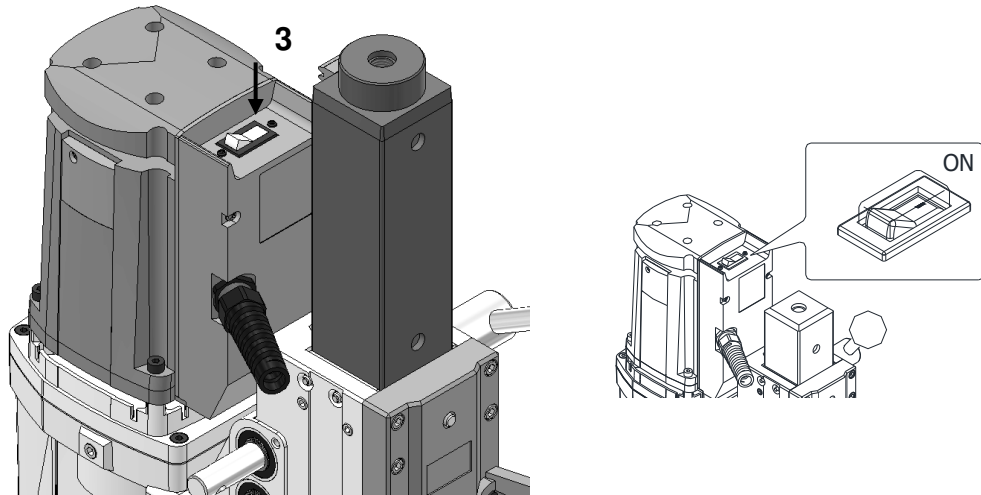

8.2.1

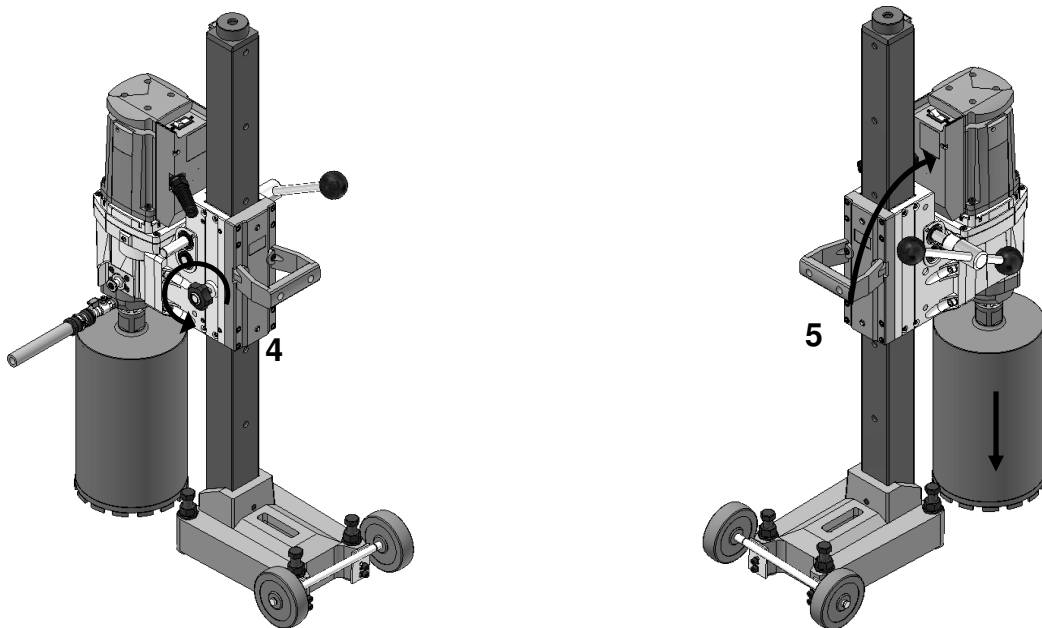

## STANDARD ACCESSORIES

Check that all of the following items are included in the package.

TS-405

Item	Size	Qty.
30 mm Spacer Set		1
Hex. Socket Bolt	M8x65	4
Spring Washer	2-8	4
Quick Release Handle Set		1
Caster Assy		1
Hex. Socket Bolt w/SW	M6x15	4

Item in the tool bag	Size	Qty.
Single-End Spanner	36 mm	1
Allen Key	4 mm	1
Allen Key	6 mm	1
Square Washer	W1/2	1
Core Removal Lasso		1
Nut Driver	7	1
Ratchet Wrench	19x21 mm	1
Hex. Socket Bolt w/SW	M8x35	4

AB61

TS-405(AB61) swivel base drill stand includes the following items in addition to the items in TS-405 fixed base drill stand.

Item	Size	Qty.
Allen Key	10 mm	1
Allen Key	8 mm	1
Ring Wrench	19x21 mm	1



# CONTENTS

NAME OF EACH PART .....	i
ILLUSTRATIONS OF OPERATION.....	iii
STANDARD ACCESSORIES .....	vii
CONTENTS .....	viii
1. GENERAL INFORMATION.....	1
1.1 Safety notes and their meanings .....	1
1.2 Pictograms.....	1
1.3 Model name plate label.....	2
1.4 Other label .....	2
2. DESCRIPTION .....	3
2.1 Applications of the machine.....	3
3. IMPORTANT NOTICE .....	3
4. SAFETY .....	4
4.1 Safety precautions .....	4
4.1.1 General power tool safety warnings .....	4
4.1.2 Diamond drill safety warnings .....	5
4.1.3 Additional safety precautions .....	6
4.2 Safety devices .....	7
5. TECHNICAL DATA .....	8
5.1 Diamond core drilling machine .....	8
5.2 Noise information and vibration values determined in accordance with EN 62841 .....	9
6. BEFORE USE.....	10
6.1 Connecting the drill motor to the carriage block.....	10
6.2 Attaching the Caster Assy to the base .....	10
6.3 Extension cords .....	10
6.4 PRCD, GFCI and RCD .....	11
6.5 Attaching AB61 (Option) .....	11
7. SETTING UP .....	12
7.1 Fastening the drill stand with an anchor .....	12
7.2 Adjusting the angle of the drill stand with AB61 (Option) .....	13
7.3 Mounting the drill motor with the carriage block on the drill stand .....	14
7.3.1 Attaching the quick release handle to the carriage block .....	14
7.3.2 Attaching the drill motor with the carriage block to the drill stand .....	14
7.3.3 Adjusting the carriage block .....	14
7.4 Attaching a core bit.....	15
7.5 Attaching the swivel top to the swivel top column (Option) .....	15
7.6 Shifting the gear.....	17
7.7 Preparation for water supply .....	17
8. OPERATION .....	18
8.1 Precautions for the drilling operation .....	18
8.1.1 General .....	18
8.1.2 Electrical safety .....	18
8.1.3 Others .....	18
8.2 Operating procedure.....	19
8.2.1 Start drilling .....	19
8.2.2 Restart after the circuit protector trips.....	19
8.2.3 Core bit jamming .....	19
8.2.4 Stop drilling.....	19
8.2.5 Remove cores with the core removal lasso .....	20
8.2.6 Use of the swivel top (Option) for deep drilling .....	20
9. CLEANING .....	21

10. ACCESSORIES (OPTION).....	21
11. MAINTENANCE.....	22
11.1 Replacing the carbon brushes .....	22
12. TRANSPORT AND STORAGE.....	22
13. TROUBLESHOOTING.....	23
14. DISPOSAL.....	24
15. LIMITED WARRANTY .....	24
16. DIMENSIONS .....	25
17. PARTS LIST.....	26

# 1. GENERAL INFORMATION

## 1.1 Safety notes and their meanings

In this manual, warning signs are classified into four levels based on the level of potential risks.

 **DANGER**

This symbol indicates the imminent risks that lead to death or serious injury to the operators and others, unless the safety instructions are observed.

 **WARNING**

This symbol indicates the potential risks that may lead to death or serious injury to the operators and others, unless the safety instructions are observed.

 **CAUTION**

This symbol indicates the potential risks that lead to injury to the operators and others, unless the safety instructions are observed.

**NOTE**

This symbol is used for the information that is necessary for you to know.

## 1.2 Pictograms



Make sure to read and understand this manual thoroughly before starting the operation.



The machine can be a dangerous tool if it is not used correctly. Incorrect and careless use can lead to death or serious injury to the operators and/or others.



Do not dispose of this machine with domestic waste. Follow your national law.

When you dispose of concrete slurry, ask your local authorities for applicable regulations.

### 1.3 Model name plate label

This machine has a label as shown in the figures below. When the label is illegible or lost, contact a Shibuya authorized dealer to get a new one.  
The serial number on the model name plate indicates the production year and month of the drill motor as shown in the sample below.

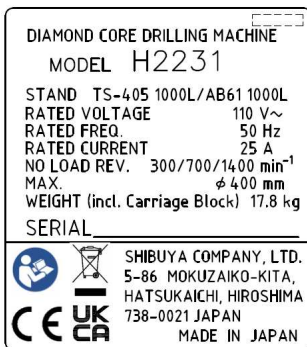
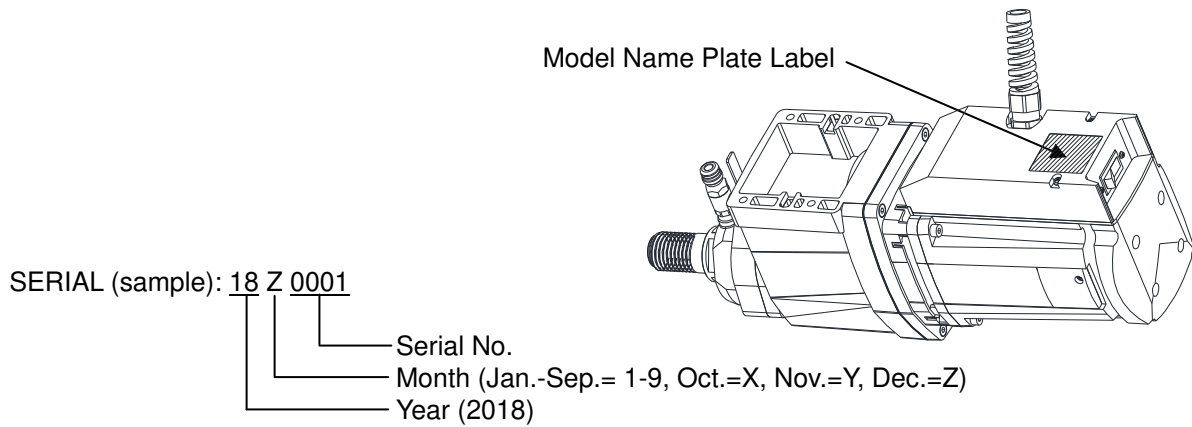

110 V model



110-120 V model

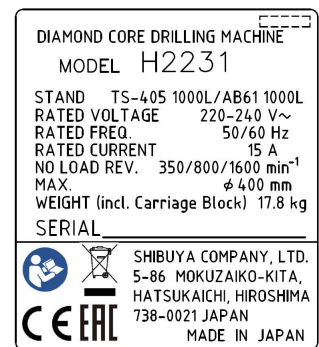

220-240 V model

### 1.4 Other label

This machine has labels as shown in the figure below. When the label is illegible or lost, contact a Shibuya authorized dealer to get a new one.

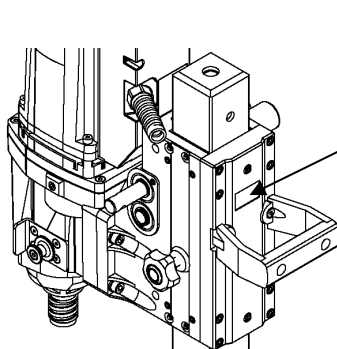
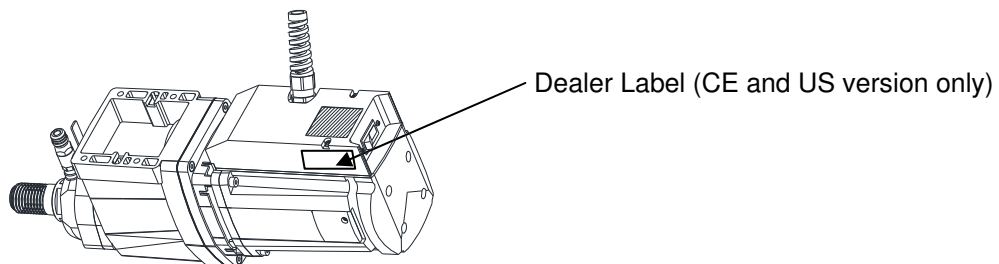

Carriage Block Label

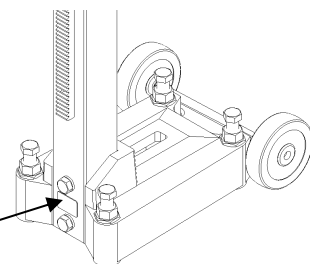
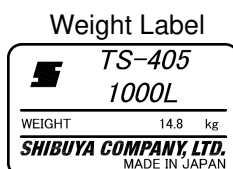
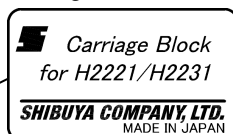

## 2. DESCRIPTION

This machine consists of the drill motor and drill stand. This machine is designed for wet drilling in walls and floors made of concrete, natural stone and other mineral building materials using diamond core bits (diamond tools). The drill motor must be mounted on a Shibuya drill stand: TS-405 or TS-405 (AB61). Handheld use is not permissible.

### 2.1 Applications of the machine

- Drilling reinforced concrete for piping works
- Extracting concrete cores for strength testing
- Overall drilling in reinforced concrete, except drilling upwards

## 3. IMPORTANT NOTICE

---

### DANGER

- **Improper use of the diamond core drilling machine may lead to serious or fatal injuries. Read, understand and follow this manual carefully before the operation.**
  - **This machine is designed for core drilling operations. Never use it for any other purposes. Do not use it as a hand-held core drill.**
- 

### WARNING

- **This machine is intended for industrial applications by experienced operators.**
  - **Always use common sense and plan your work to avoid injuries. It is not possible to cover all risks which may occur during the operations in this manual. Therefore, enough care must be taken to ensure the safe operation of this machine.**
- 

### NOTE

- Shibuya Company, Ltd. reserves the right to change specifications of products without any prior notices.
  - Copyright reserved on this manual. Publication of the technical information and drawings in this manual, and duplication without prior permission of Shibuya Company, Ltd. is prohibited.
-

## 4. SAFETY

### 4.1 Safety precautions

The safety precautions given in the following section contain all general safety precautions for power tools which, in accordance with the applicable standards, require to be listed in the operating instructions.

Accordingly, some of the rules listed may not be relevant to this power tool.

#### 4.1.1 General power tool safety warnings

---

 **WARNING**

**Read all safety warnings, instructions, illustrations and specifications provided with this power tool.** Failure to follow all instructions listed below may result in electric shock, fire and/or serious injury.

---

**Save all warnings and instructions for future reference.**

The term "power tool" in the warnings refers to your mains-operated (corded) power tool or battery-operated (cordless) power tool.

##### 1) Work area safety

- a) **Keep work area clean and well lit.** Cluttered or dark areas invite accidents.
- b) **Do not operate power tools in explosive atmospheres, such as in the presence of flammable liquids, gases or dust.** Power tools create sparks which may ignite the dust or fumes.
- c) **Keep children and bystanders away while operating a power tool.** Distractions can cause you to lose control.

##### 2) Electrical safety

- a) **Power tool plugs must match the outlet. Never modify the plug in any way. Do not use any adapter plugs with earthed (grounded) power tools.** Unmodified plugs and matching outlets will reduce risk of electric shock.
- b) **Avoid body contact with earthed or grounded surfaces, such as pipes, radiators, ranges and refrigerators.** There is an increased risk of electric shock if your body is earthed or grounded.
- c) **Do not expose power tools to rain or wet conditions.** Water entering a power tool will increase the risk of electric shock.
- d) **Do not abuse the cord. Never use the cord for carrying, pulling or unplugging the power tool. Keep cord away from heat, oil, sharp edges or moving parts.** Damaged or entangled cords increase the risk of electric shock.
- e) **When operating a power tool outdoors, use an extension cord suitable for outdoor use.** Use of a cord suitable for outdoor use reduces the risk of electric shock.
- f) **If operating a power tool in a damp location is unavoidable, use a residual current device (RCD) protected supply.** Use of an RCD reduces the risk of electric shock.

##### 3) Personal safety

- a) **Stay alert, watch what you are doing and use common sense when operating a power tool. Do not use a power tool while you are tired or under the influence of drugs, alcohol or medication.** A moment of inattention while operating power tools may result in serious personal injury.
- b) **Use personal protective equipment. Always wear eye protection.** Protective equipment such as a dust mask, non-skid safety shoes, hard hat or hearing protection used for appropriate conditions will reduce personal injuries.
- c) **Prevent unintentional starting. Ensure the switch is in the off-position before connecting to power source and/or battery pack, picking up or carrying the tool.** Carrying power tools with your finger on the switch or energising power tools that have the switch on invites accidents.
- d) **Remove any adjusting key or wrench before turning the power tool on.** A wrench or a key left attached to a rotating part of the power tool may result in personal injury.

- e) **Do not overreach. Keep proper footing and balance at all times.** This enables better control of the power tool in unexpected situations.
- f) **Dress properly. Do not wear loose clothing or jewellery. Keep your hair and clothing away from moving parts.** Loose clothes, jewellery or long hair can be caught in moving parts.
- g) **If devices are provided for the connection of dust extraction and collection facilities, ensure these are connected and properly used.** Use of dust collection can reduce dust-related hazards.
- h) **Do not let familiarity gained from frequent use of tools allow you to become complacent and ignore tool safety principles.** A careless action can cause severe injury within a fraction of a second.

#### 4) Power tool use and care

- a) **Do not force the power tool. Use the correct power tool for your application.** The correct power tool will do the job better and safer at the rate for which it was designed.
- b) **Do not use the power tool if the switch does not turn it on and off.** Any power tool that cannot be controlled with the switch is dangerous and must be repaired.
- c) **Disconnect the plug from the power source and/or remove the battery pack, if detachable, from the power tool before making any adjustments, changing accessories, or storing power tools.** Such preventive safety measures reduce the risk of starting the power tool accidentally.
- d) **Store idle power tools out of the reach of children and do not allow persons unfamiliar with the power tool or these instructions to operate the power tool.** Power tools are dangerous in the hands of untrained users.
- e) **Maintain power tools and accessories. Check for misalignment or binding of moving parts, breakage of parts and any other condition that may affect the power tool's operation. If damaged, have the power tool repaired before use.** Many accidents are caused by poorly maintained power tools.
- f) **Keep cutting tools sharp and clean.** Properly maintained cutting tools with sharp cutting edges are less likely to bind and are easier to control.
- g) **Use the power tool, accessories and tool bits etc. in accordance with these instructions, taking into account the working conditions and the work to be performed.** Use of the power tool for operations different from those intended could result in a hazardous situation.
- h) **Keep handles and grasping surfaces dry, clean and free from oil and grease.** Slippery handles and grasping surfaces do not allow for safe handling and control of the tool in unexpected situations.

#### 5) Service

- a) **Have your power tool serviced by a qualified repair person using only identical replacement parts.** This will ensure that the safety of the power tool is maintained.

### 4.1.2 Diamond drill safety warnings

- a) **When performing drilling that requires the use of water, route the water away from the operator's work area or use a liquid collection device.** Such precautionary measures keep the operator's work area dry and reduce the risk of electrical shock.
- b) **Operate power tool by insulated grasping surfaces, when performing an operation where the cutting accessory may contact hidden wiring or its own cord.** Cutting accessory contacting a "live" wire may make exposed metal parts of the power tool "live" and could give the operator an electric shock.
- c) **Wear hearing protection when diamond drilling.** Exposure to noise can cause hearing loss.
- d) **When the bit is jammed, stop applying downward pressure and turn off the tool.** Investigate and take corrective actions to eliminate the cause of the bit jamming.
- e) **When restarting a diamond drill in the workpiece check that the bit rotates freely before starting.** If the bit is jammed, it may not start, may overload the tool, or may cause the diamond drill to release from the workpiece.
- f) **When securing the drill stand with anchors and fasteners to the workpiece, ensure that the anchoring used is capable of holding and restraining the machine during use.** If the workpiece is weak or porous, the anchor may pull out causing the drill stand to release from the workpiece.
- g) **When drilling through walls or ceilings, ensure to protect persons and the work area on the other side.** The bit may extend through the hole or the core may fall out on the other side.

- h) **Do not use this drill tool for overhead drilling with water supply.** Water entering the power tool will increase the risk of electric shock.

### 4.1.3 Additional safety precautions

#### Personal safety

- Tampering with or modification of the machine is **not** permitted.
- The machine is **not intended for use by inexperienced persons** who have received no special training.
- Keep the machine out of reach of children.
- **Avoid touching rotating parts.** Switch the machine on only after it is in the position at the workpiece. Touching rotating parts, especially rotating accessory tools, may lead to injury.
- Avoid skin contact with drilling slurry.
- Dust from materials, such as paint containing lead, some kinds of wood, concrete / masonry / stone containing silica, and minerals as well as metal, may be injurious to health. Contact with or inhalation of the dust may cause allergic reactions and/or respiratory or other diseases to the operator or bystanders. Certain kinds of dust are classified as carcinogenic such as oak and beech dust, especially in conjunction with additives for wood conditioning (chromate, wood preservative). Material containing asbestos must only be handled by specialists. Use a dust removal system that is as effective as possible. Accordingly, use a suitable vacuum cleaner of the type recommended by **specialists** for wood dust and/or mineral dust and which is designed for use with this power tool. Ensure that the workplace is well ventilated. The use of a dust mask suitable for the particular type of dust is recommended. Observe national regulations applicable to the materials on which you intend to use the machine.
- The diamond core drilling machine and the diamond core bit are heavy pieces of equipment. There is a risk of crushing parts of the body. **The user and any other persons in the vicinity must wear suitable eye protection, a hard hat, ear protection, protective gloves and safety footwear while the machine is in use.**

#### Careful handling and use of electric tools

- Make sure that the drill motor is correctly fastened in the drill stand.
- Ensure that the accessory tools used have a spindle thread that is compatible with the drilling machine and that they are secured in the spindle correctly.

#### Electrical safety

- **Avoid using extension cords with multiple power outlets** and the simultaneous use of several machines connected to one extension cord.
- Never plug into the socket that is not equipped with an earth (ground) conductor.
- Before beginning work, **check the working area (e.g. using a metal detector) to ensure that no concealed electric cables or gas and water pipes** are present. External metal parts of the machine may become live, for example, when an electric power line is damaged accidentally. This presents a serious risk of electric shock.
- Make sure that the supply cord is not pinched and damaged as the carriage block advances.
- **Never operate the machine without the PRCD.** Never operate machines without an isolating transformer if PRCD is not equipped. Test the PRCD each time before use.
- **Check the machine's supply cord at regular intervals** and have it replaced by a qualified specialist if found to be damaged. If the machine's supply cord is damaged it must be replaced by Shibuya authorized dealer. Check extension cords at regular intervals and replace them if found to be damaged. Do not touch the supply cord or extension cord if it is damaged while working. Disconnect the supply cord plug from the power outlet. Damaged supply cords or extension cords present a risk of electric shock.

#### Workplace

- **Approval must be obtained from the site engineer or architect prior to beginning drilling work.** Drilling work on buildings and other structures may influence the static equilibrium of the structure, especially when steel reinforcing bars or load-bearing components are cut through.
- If the drill stand has not been fastened correctly, always move the drill motor mounted on the drill stand all the way down in order to prevent the stand from falling over.
- Keep the supply cord, extension cord, water hose and vacuum hose away from rotating parts of the machine.



## 4.2 Safety devices

Circuit protector (Main switch)

---

 **WARNING**

**Do not modify the circuit protector.**

---

This machine is equipped with a circuit protector for safer operation, avoiding overload of the drill motor which may cause fire or smoke.

Clutch system

---

 **CAUTION**

**Do not tighten the clutch by yourself.**

---

This machine is equipped with clutch system to reduce the risks when the core bit is jammed. This system also plays a role in protecting the power train.

## 5. TECHNICAL DATA

### 5.1 Diamond core drilling machine

When powered by a generator or transformer, the generator or transformer's power output must be at least 5.2 kVA. The operating voltage of the transformer or generator must always be the voltage stated on the model name plate label.

The specification may vary for country-specific versions. Please refer to the model name plate label for details of its voltage, frequency, current and input power ratings.

Information for users as per EN 61000-3-11: Switching on causes a brief drop in voltage. Other appliances may be negatively affected on mains supplies where conditions are unfavorable. No malfunctions are to be expected in mains supplies with an impedance of less than 0.162 ohms (220-240 V).

Motor Model	H2221		H2231		
Rated Voltage (V)	120	220-240	110	110-120	220-240
Rated Frequency (Hz)	50/60		50	50/60	
Rated Input (W)	3240	3450	2750	3450	3450
Rated Current (A)	27	15	25	30	15
Spindle Rev. at No Load (min <sup>-1</sup> )	300/700	350/850	300/700/1400		350/800/1600
Spindle Rev. at Rated Load (min <sup>-1</sup> )	230/550	190/460	230/550/1080		200/500/950
Spindle Thread	A-ROD		UNC 1 1/4" or A-ROD		
Weight (incl. Carriage Block excl. Plug and Cord) (kg)	16.9 (37 lbs.)		17.8 (39 lbs.)		

Drill Stand Model	TS-405	
Max. Applicable Core Bit Diameter w/30mm Spacer (mm)	400 (16")	
Overall Height (mm)	1003 (40")	
Base Size *1 (mm)	176 x 275 (7 x 11")	
Total Stroke (mm)	633(24.9")	
Weight (Kg)	14.8 (33 lbs)	

Swivel Base Model	AB61
Applicable Drill Stand Model	TS-405
Max Column Tilt Angle	44 degrees backward / forward
Angle Adjustment	4 degrees intervals
Weight	5.9 kg (13 lbs)

#### NOTE

Never use the machine at the place where the ambient temperature is below 0 degrees C (32 degrees F) or above 40 degrees C (104 degrees F).

## 5.2 Noise information and vibration values determined in accordance with EN 62841

The sound pressure and vibration values given in these instructions have been measured in accordance with a standardized test and may be used to compare one power tool with another. They may be used for a preliminary assessment of exposure. The data given represents the main applications of the power tool. However, if the power tool is used for different applications, with different accessory tools, or is poorly maintained, the data may vary. This may significantly increase exposure over the total working period. An accurate estimation of exposure should also take into account the times when the power tool is switched off, or when it is running but not actually being used for a job. This may significantly reduce exposure over the total working period. Identify additional safety measures to protect the operator from the effects of noise and/or vibration, for example: maintain the tool and the accessories and organization of work patterns.

The sound pressure and vibration have been measured under the following condition in accordance with EN62841.

Drill motor	Speed range	Core bit dia.	Concrete formulation
H2231 (110 / 220-240 V)	L (Low speed)	300 mm	The water/cement mass ratio : 0.56 Compressive strength : 44 N/mm <sup>2</sup>

### Noise emission values determined in accordance with EN 62841

Drill motor	H2231 110 V
Sound (power) level ( $L_{WA}$ )	100.6 dB(A)
Uncertainty for the sound power level ( $K_{WA}$ )	3 dB(A)
Sound pressure level ( $L_{pA}$ )	86.6 dB(A)
Uncertainty for the sound pressure level ( $K_{pA}$ )	3 dB(A)

Drill motor	H2231 220-240 V
Sound (power) level ( $L_{WA}$ )	106 dB(A)
Uncertainty for the sound power level ( $K_{WA}$ )	3 dB(A)
Sound pressure level ( $L_{pA}$ )	89.7 dB(A)
Uncertainty for the sound pressure level ( $K_{pA}$ )	3 dB(A)

### Total vibration (vector sum of three directions) measured in accordance with EN 62841

Triaxial total vibration (vector sum of vibration) at the quick release handle (feed handle) does not exceed 2.5 m/s<sup>2</sup> in accordance with EN 62841.

## 6. BEFORE USE

When you purchase a complete set that consists of Drill Motor and Drill Stand, the packing is divided into two packages. The drill motor H2221/H2231 (excluding carriage block) in the polyethylene bag is packed in the carton box. The drill stand TS-405/TS-405(AB61) including carriage block is packed in the carton box. Assemble the components as described in this manual after unpacking.

### 6.1 Connecting the drill motor to the carriage block

#### ⚠ WARNING

- Make sure the drill motor is switched off and disconnected from the power supply.
- Comply with the tightening torque stated on this manual. Inadequate torque may lead to death or serious injury to the operators and others.

Connecting the drill motor without the 30mm spacer:

Use 4 pieces of hex. socket bolts w/SW (M8x35) which are included in the tool bag.

The tightening torque is 35 Nm (25 lbf·ft).

Connecting the drill motor with the 30mm Spacer:

Use 4 pieces of hex. socket bolts (M8x65) and 4 pieces of spring washers (2-8) which are supplied with the 30 mm spacer. The tightening torque is 35 Nm (25 lbf·ft).

Refer to the figure below.

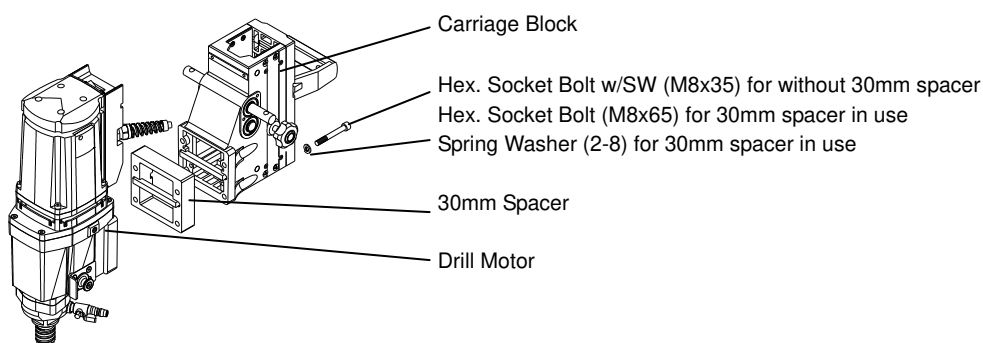

### 6.2 Attaching the Caster Assy to the base

Use 4 pieces of hex. socket bolts w/SW (M6x15) which are supplied with the Caster Assy.

The tightening torque is 13 Nm (9 lbf·ft).

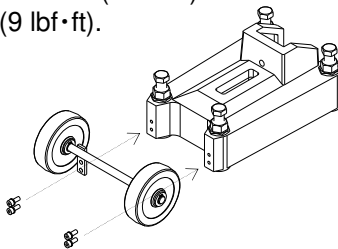

### 6.3 Extension cords

#### ⚠ CAUTION

- For 220-240 V model, use only extension cords of a type approved for the application and with conductor cross section 2 mm<sup>2</sup> or larger, and the maximum allowable length of the cord is 35 meters (115 ft).
- For 110-120 V model, use only extension cords of a type approved for the application and with conductor cross section 3.5 mm<sup>2</sup> (12AWG) or larger, and the maximum allowable length of the cord is 30 meters (98 ft).
- Never turn on the drill motor while the extension cords are circularly bundled. The circularly bundled extension cords may act as a coil which generates a magnetic field and heat.

## 6.4 PRCD, GFCI and RCD

### 220-240 V model

#### **⚠ WARNING**

**Always use a Portable Residual Current Device (PRCD) also known as a Ground Fault Circuit Interrupter (GFCI).**

Test and reset the PRCD before each use.

1. Plug into an earthed/grounded power outlet.
2. Press the "I" or "RESET" button on the PRCD.  
The indicator lights up.
3. Press the "O" or "TEST" button on the PRCD.  
The indicator goes out.

### 110-120 V model

#### **⚠ WARNING**

**Always use a Residual Current Device (RCD) also known as a Ground Fault Circuit Interrupter (GFCI).**

Refer to the manual of the RCD or GFCI.

Specifications of an RCD or GFCI

Power voltage	110-120 V
Breaking current	30 A or more
Current leakage	10 mA or less

## 6.5 Attaching AB61 (Option)

#### **⚠ WARNING**

**Comply with the tightening torque stated on this manual. Inadequate torque may lead to death or serious injury to the operators and others.**

#### **NOTE**

Make sure to use both the plain washers and the spring washers with the bolts which are supplied with the AB61. When attaching the column to the fixed type base, only the spring washers and the bolts need to install. In case of attaching the column to the AB61, the plain washers need to be used in addition to the spring washers and the bolts.

- 1) Pull out the drill motor with the carriage block from the TS-405 fixed base drill stand, and remove the bolts fixing the column and the base. (Fig.1)  
Store the removed base, bolts, and spring washers for future use.
- 2) Install the removed column to the AB61. The tightening torque for the bolts is 29 Nm (21 lbf·ft) each. (Fig.2)

Fig.1

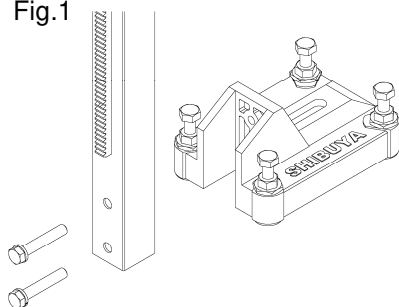
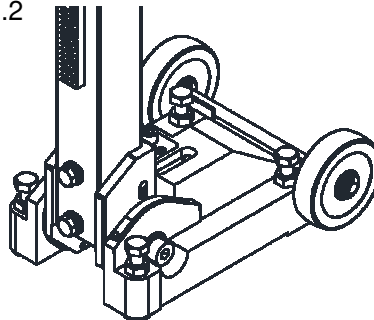

Fig.2



## 7. SETTING UP

### 7.1 Fastening the drill stand with an anchor

---

**⚠ DANGER**

Fasten the drill stand firmly on the material to be drilled, otherwise the machine may become unstable during the operation and it may lead to death or serious injury to the operators and others.

---

**⚠ WARNING**

- Read and follow the instruction manual of the anchor bolts used with the machine.
  - Use anchor bolts which tensile strength is greater or equal to 24.5 kN (5.5 klbf).
  - When fastening the drill stand to a wall, countermeasures must be taken to avoid falling hazards.
  - Never fasten the drill stand to a ceiling.
- 

**⚠ CAUTION**

- Transportation, installation, and dismantling of the machine must be done by two or more operators for safety.
- 

- 1) Drill a hole for Drop-In anchor, using a hammer drill.

The ideal distance between the center of the hole to be drilled and the anchor hole;

TS-405 fixed base drill stand

- a) With 30 mm spacer: 328-388 mm (13-15")
- b) Without 30 mm spacer: 298-358 mm (12-14")

TS-405(AB61) swivel base drill stand

- a) With 30 mm spacer: 352-395 mm (14-15")
- b) Without 30 mm spacer: 322-365 mm (13-14")

- 2) Clean out the anchor hole.
- 3) Insert the anchor into the hole, and hammer a setting tool to fasten the anchor firmly.
- 4) Screw a threaded bolt into the anchor.
- 5) Set the drill stand, passing the bolt through the anchor slot.
- 6) Insert the W1/2 square washer (standard accessory) to the bolt.
- 7) Insert a hex. nut to the bolt. Then, tighten the nut temporarily.
- 8) Adjust the leveling bolts to stabilize the base. Tighten the nut on the leveling bolts to fix the leveling bolts firmly.
- 9) Tighten the hex. nut firmly using a spanner.

## 7.2 Adjusting the angle of the drill stand with AB61 (Option)

### ⚠ CAUTION

- Before tilting the column, ensure that the drill stand is firmly fastened by an anchor bolt to the material to be drilled, and the drill motor with the carriage block is removed from the column.
- The tilting operation of the column must be carried out by two or more operators for safety.
- Take care not to pinch fingers between the column and the base.
- Before fixing the column at a desired angle, ensure that the gear is properly meshed and the bolt/nut is tightened securely. Insufficient meshing of the gear may lead to collapse of the column while the operation which may lead to injury to operators and/or others.

### NOTE

- Do not readjust the leveling bolts after the base is fastened by an anchor bolt firmly. It may cause damage to the base.
- The angle is adjustable at intervals of 4 degrees by the column. Moreover, turning 2 pieces of the front leveling bolts by approximately 2 revolutions tilts the base 1 degree backward as shown in the figure below. Do not make this leveling bolts' base adjustment after fastening the base by an anchor bolt. (Fig. a)
- The angle scale indicates approximate angle degrees. If higher precision is required, alternative measuring method should be used.
- The center of the column is offset 3.5 mm (0.14") away from the center of the anchor slot. (Fig. b)

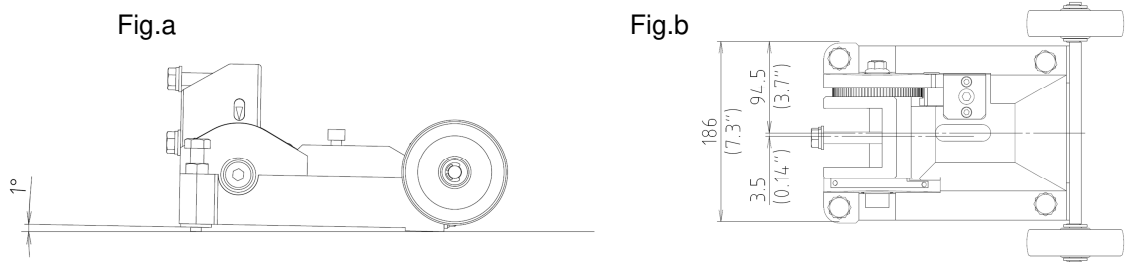

Follow the procedure below.

- 1) Hold the column by an operator to prevent unintentional falling down of the column. (Fig.1)
- 2) While the column is held by the operator, loosen (1) M12 nut and loosen (2) M10x30 bolt approximately 4 revolutions to release the gear. (Fig.2)
- 3) Tilt the column to the desired angle referring to the angle scale. Ensure that the indication label is aligned with a line of the angle scale. (Fig.3-a & b)  
Misalignment of the indication label and a line of the scale may cause damage to the gear when the column is fixed.
- 4) Tighten the (2) M10x30 bolt and then the (1) M12 nut. (Fig.4)  
The tightening torque for the (2) M10x30 bolt is 25 Nm (18 lbf · ft).  
The tightening torque for the (1) M12 nut is 60 Nm (44 lbf · ft).

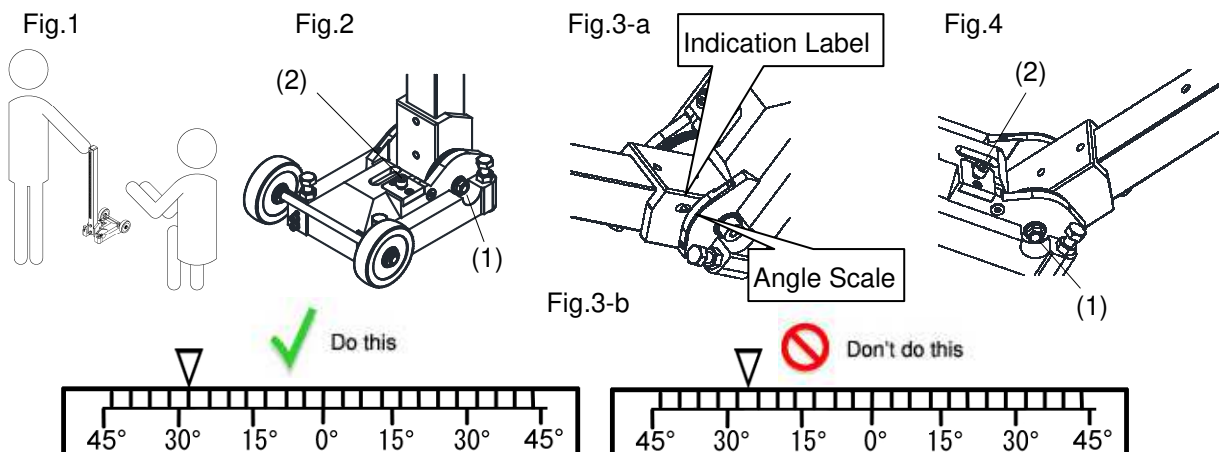

## 7.3 Mounting the drill motor with the carriage block on the drill stand

### **⚠ WARNING**

**Make sure the drill motor is switched off and disconnected from the power supply.**

#### 7.3.1 Attaching the quick release handle to the carriage block

### **⚠ CAUTION**

**Take care not to pinch fingers between the retainer and the quick release handle (feed handle).**

Follow the procedure below.

- 1) Attach the quick release handle (feed handle) to either left or right side of the carriage block.
- 2) Insert the retainer (pin) to fix the quick release handle to the carriage block.  
Make sure that the handle is firmly-fastened.

#### 7.3.2 Attaching the drill motor with the carriage block to the drill stand

### **⚠ CAUTION**

- **Take care not to pinch fingers between the carriage block and the column when mounting the motor.**
- **Hold the motor tightly with both hands as below when mounting the motor on the drill stand.**
- **The quick release handle (feed handle) starts turning once the pinion gear of the carriage block and the rack gear of the column are engaged. Take care not to hit the handle against your body when the carriage block is sliding.**
- **Tighten the stopper-knob (carriage brake) to prevent unintentional sliding down of the carriage block.**

Follow the procedure below.

- 1) Loosen the stopper-knob.
- 2) Mount the drill motor with the carriage block on the drill stand.
- 3) Turn the quick release handle to feed the drill motor to a suitable position.
- 4) Tighten the stopper-knob.

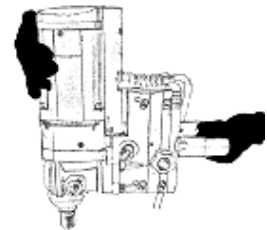

#### 7.3.3 Adjusting the carriage block

### **NOTE**

Adjustment of the carriage block plays an important role in core drilling operations. Unacceptable play of the carriage block will cause a radial runout of the core bit which may lead to unsymmetrical contact of the shank and/or jamming of the core bit while the operation. If the carriage block is too tight, the resistance will increase and the carriage block does not slide smoothly along the column. Adjust the carriage block a little tight and within the operator can reasonably feed the motor.

The carriage block must be adjusted if there is play between the carriage block and the column. Follow the procedure below.

- 1) While holding the feed handle, loosen the stopper-knob.
- 2) Use a 4 mm Allen key to tighten / loosen hex. socket screws.  
4 pieces of the hex. socket screws on the left side of the carriage block are for adjusting the play of right and left.
- 3) Turn the feed handle back and forth while checking the play.
- 4) Use a 4 mm Allen key to tighten / loosen hex. socket screws.  
2 pieces of the hex. socket screws on the back side of the carriage block are for adjusting the play of back and forth.
- 5) Turn the feed handle back and forth while checking the play.
- 6) Tighten the stopper-knob.



## 7.4 Attaching a core bit

### ⚠ WARNING

- Make sure the drill motor is switched off and disconnected from the power supply.
- Never use the drill motor's power to attach a core bit.

### ⚠ CAUTION

Wear protective gloves when changing a core bit. A core bit becomes hot as a result of use. It may have sharp edges.

### NOTE

- Use core bits in conformity with EN13236 and/or EN12413.
- For safety reason, each damaged (cracked) bit must be replaced.
- Leaving a core bit attached to the spindle may cause adherence of the core bit to the spindle. Using a quick disconnect tool such as the Slider may help to avoid such adherence.

Attach a core bit to the spindle firmly and securely by rotating the core bit.

Ensure that the end surface of the core bit is aligned with the surface of the spindle, so that the core bit can not be tightened any further.

## 7.5 Attaching the swivel top to the swivel top column (Option)

### ⚠ CAUTION

- The attaching procedure of the swivel top must be carried out by two or more operators for safety. Ensure to not swiveling the carriage block on the swivel top unintentionally.
- Before attaching the swivel top, ensure that the length of threaded bolt is 314 mm (12.4") from the top of the column, otherwise the swivel top will come off from the column and may lead to injuries.
- The swivel top part is swiveling the carriage block and the motor purpose only. Never use this part for drilling.

### NOTE

The swivel top (option) is only correspondent with the swivel top column.

Purpose of the swivel top:

The swivel top makes changing the core bits easier for deep drilling while the motor and carriage block are positioned on the swivel top part.

Fig.1 illustrates when the first step of drilling is done. For deep drilling, the core must be removed from the material, however the core bit interferes the removal of the core.

Fig.2 illustrates that using the swivel top enables rotating the carriage block with motor.

Fig.3 illustrates that removing the core while the carriage block and the motor is still on the column.

Utilizing the swivel top makes changing or extending the core bit easier improving the efficiency of the drilling operation.

Fig.1

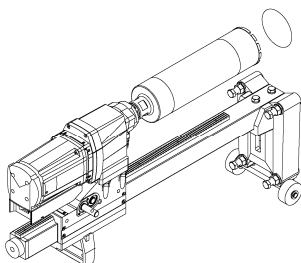

Fig.2

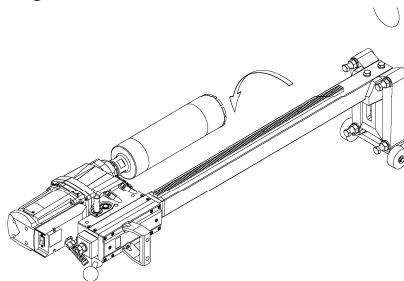
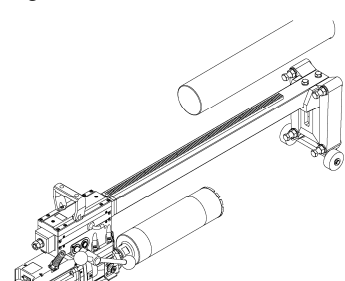

Fig.3



For attaching the swivel top, follow the procedure below.

- 1) Ensure that the drill stand is firmly fastened to the material. Mount the drill motor with the carriage block on the drill stand.
- 2) Screw the M16x330 threaded bolt into the column. Ensure that the length of threaded bolt is 314 mm (12.4") from the top of the column. (Fig.1)
- 3) Tighten the M16 hex. nut to fix the threaded bolt. The tightening torque for the nut is 73 Nm (54 lbf · ft). (Fig.1)
- 4) Attach the swivel top. Insert M16 plain washer and M16 hex. nut, passing through the threaded bolt. Tighten the M16 hex. nut. The temporary tightening torque is 60 Nm (44 lbf · ft). (Fig.2)

### NOTE

**The quantity of the nut used in the procedure 4) is only 1 piece.**

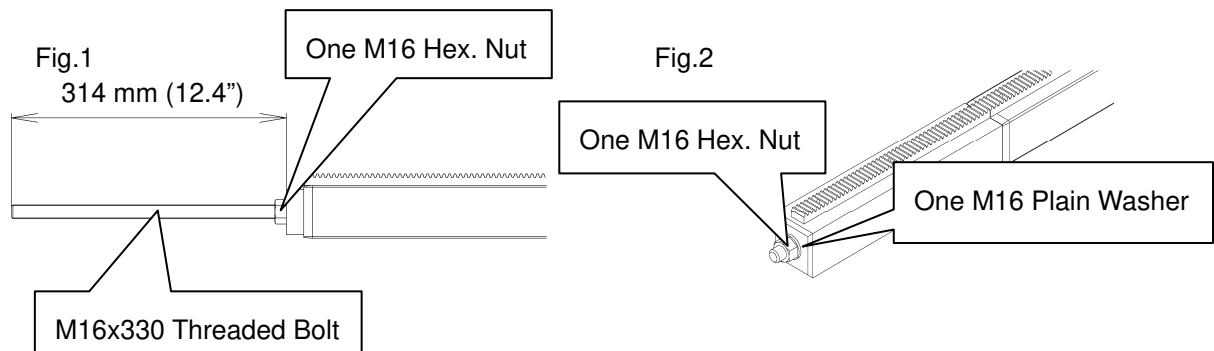

- 5) Slide the carriage block to the swivel top part. Ensure to hold the drill motor by an operator to avoid unintentional rotating of the motor. (Fig.3)
- 6) While the drill motor is held by the operator, adjust the tightening torque of the nut which was temporary tightened in the procedure 4) to ensure that the swivel top with the carriage block and the drill motor rotates safely and properly. Ensure that the tightening torque is adequate that the swivel top does not rotate unintentionally nor does not rotate at all when in use. (Fig.4)
- 7) After confirming that the swivel top rotates safely and properly, fix the nut adjusted in the procedure 6) by using another M16 hex. nut as a double nut. The tightening torque for the double nut is 73 Nm (54 lbf · ft). Ensure that the end of the threaded bolt is flush with the upper surface of the nut. (Fig.5)

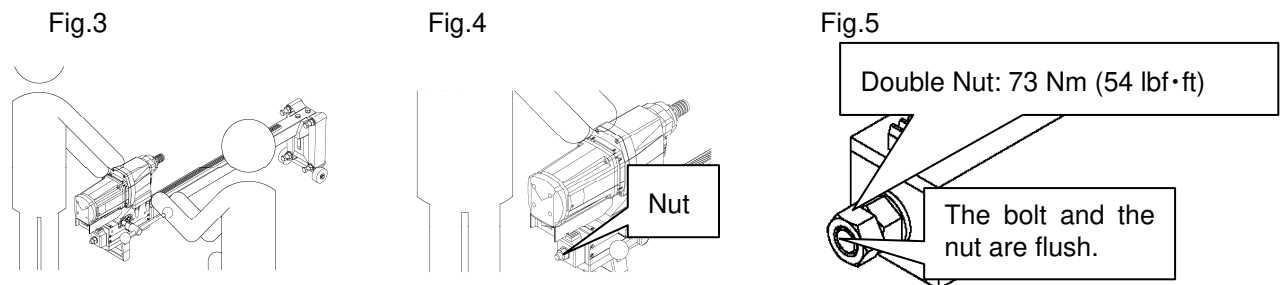

For the use of the swivel top, refer to 8.2.6 Use of the swivel top (Option) for deep drilling on page 20.

## 7.6 Shifting the gear

### WARNING

**Make sure the drill motor is switched off and disconnected from the power supply.**

### CAUTION

**The gear shifting must be done when the motor is completely stopped.**

H2221 drill motor has a 2-speed gearbox. "H" is a high-speed range, and "L" is a low speed range. H2231 drill motor has a 3-speed gearbox. "H" is a high-speed range, "M" is a middle speed range, and "L" is a low speed range.

According to the size or diameter of the core bit attached, a proper gear must be chosen.

Refer to the following table.

### NOTE

This table is advisory only. Maximum drilling diameter depends on the hardness of the material to be drilled.

Drill Motor Model	Speed Range	Rev. (No-Load)		Recommended Drilling Diameter
		110-120 V	220-240 V	
H2221	H	700 min <sup>-1</sup>	850 min <sup>-1</sup>	100 mm to 160 mm (4" to 6-1/4")
	L	300 min <sup>-1</sup>	350 min <sup>-1</sup>	160 mm to 400 mm (6-1/4" to 16")
H2231	H	1400 min <sup>-1</sup>	1600 min <sup>-1</sup>	Less than 80 mm (3-1/2")
	M	700 min <sup>-1</sup>	800 min <sup>-1</sup>	65 mm to 130 mm (2-1/2" to 5")
	L	300 min <sup>-1</sup>	350 min <sup>-1</sup>	130 mm to 400 mm (5" to 16")

For the gear shifting procedure, refer to the following.

- 1) Pull out the gear change knob.
- 2) Shift it to your desired position.
- 3) When the shifting is completed, the knob will be pushed back. Ensure that the knob is pushed back to the position before proceeding to the next step.

### NOTE

If the gear does not shift well, shift the gear while rotating the spindle by hand.

## 7.7 Preparation for water supply

### CAUTION

- Ensure that the water hose is not entangled with the core bit or other moving parts.
- Ensure that the water hose has an enough length for the working stroke of the carriage block.
- Ensure that the water hose is not damaged.
- Check the water supply system to ensure there are no leaks.
- Never allow water to enter the drill motor.

### NOTE

- The maximum water pressure is 3 bar.
- Use only water (tap water or fresh water).
- Maximum water temperature: 40 degrees C (104 degrees F).

Follow the procedure below.

- 1) Connect a water hose from a tap or a water supplying device to the Gardena connector / water cock of the drill motor.
- 2) Turn the swivel ring and adjust the hose position properly.

## 8. OPERATION

### 8.1 Precautions for the drilling operation

**⚠ DANGER**

- **The following instructions are essential safety measures that you must follow.**
- **Improper use may lead to death or serious injury to the operators and/or others.**

Ensure the following before plugging in.

#### 8.1.1 General

- Ensure that the operator has read and understood this manual.
- Ensure that the operator wears proper protective clothing such as a hard hat, protective glasses, hearing protection, dust mask, protective gloves, and non-skid safety shoes. Long hair must be tied up.
- Depending on the applicable standard, take care not to stay in the environment which exceeds the allowable sound level for a long time.
- Confirm that the core bit is attached to the spindle properly. When it is misaligned or loose, attach it again.
- Take care not to get your face close to the air outlet.
- Do not insert your hands, arms, face, and other body parts in the working range of the carriage block.

#### 8.1.2 Electrical safety

- Never use this machine without a PRCD, GFCI or RCD.
- Do not drill in an upward from the horizontal. Water may leak in the motor.
- When drilling walls, a proper water collection device must be used.
- Check that the power supply voltage is the voltage shown on the model name plate label of the power tool. If the voltage is low, the current likely increases therefore the circuit protector trips frequently.
- Secure enough current for the machine.
- Use a correctly functioning generator or transformer.
- When powered by a generator or transformer, the generator or transformer's power output must be at least 5.2 kVA.
- Make sure that there is no damage on the power plug, cord, and power outlet. If there is any damage, contact a Shibuya authorized dealer for repair.
- Never turn on the drill motor while the extension cords are circularly bundled. The circularly bundled extension cords may act as a coil which generates a magnetic field and heat.
- Before connecting to the power supply, make sure that the main switch is in OFF (0) position. If the main switch is in ON (I) position, the drill motor unintentionally starts off when applying current, which may lead to injury to the operator or others.

#### 8.1.3 Others

- Ensure that the following portions are firmly installed;
  - a) Base and the surface of the material to be drilled.
  - b) Column and carriage block.
  - c) Carriage block and drill motor.
- Ensure that power cord, water hose, and operator's protective clothing are not touching the core bit.
- Ensure that the air inlet of the drill motor which is located on the top side of the motor is not blocked. Insufficient cooling may lead to damage of the motor.
- Ensure that any adjusting keys, wrenches, and spanners are not attached to the machine before starting the operation and while in operation.

## 8.2 Operating procedure

### 8.2.1 Start drilling

#### DANGER

- Ensure that the operator (s) stand firmly, and keep people away from the working area before starting.
- For penetration works, ensure to have proper protection for the operators as well as the people and property at the opposite side of the wall or down floor.
- Keep your hands and other body parts away from rotating parts while the drill motor is running.
- Do not apply too much pressure to the feed handle at the start of drilling. Rapid start of drilling may shatter segments of the core bit and the pieces may cause injuries. Gradually increase the pressure until stable feeding rate.
- Do not touch the metal parts of the feeding handle except the ball knob(s). It may cause electric shock and pinching fingers.

Follow the procedure below.

- 1) Insert the plug into the power outlet via a PRCD, GFCI or RCD.  
For the use of a PRCD, GFCI and RCD, refer to the clause 6.4.
- 2) Open the water cock to start supplying water.
- 3) Turn on the main switch to start the drill motor.
- 4) Loosen the stopper-knob, and start feeding the carriage block by turning the feed handle until the core bit contacts with the drilling surface.
- 5) When the tip of the core bit comes into contact, apply only light pressure until the segments of core bit completely get into the material. Then, gradually increase the pressure until stable feeding rate.

### 8.2.2 Restart after the circuit protector trips

#### WARNING

**The main switch still remains at ON (I) position even after the drill motor is forced to shut off due to situations such as the electric power failure. To avoid unintentional restart of the motor, ensure to turn off (O) the main switch immediately, after the motor is forced to shut off.**

This drill motor is equipped with a circuit protector to protect the motor. The circuit protector trips when it detects overcurrent during the operation.

To restart the drill motor, turn on the main switch again. Adjust the feed pressure so that the circuit protector does not trip.

### 8.2.3 Core bit jamming

#### WARNING

- **Make sure the drill motor is switched off and disconnected from the power supply.**

If the core bit is jammed, follow the procedure below to remove the concrete core before restarting the drill motor.

- 1) Close the water cock to stop water supply.
- 2) Unplug the drill motor from the power supply.
- 3) Remove the concrete core.
- 4) Insert the plug into the power outlet via a PRCD, GFCI or RCD again.  
For the use of a PRCD, GFCI and RCD, refer to the clause 6.4.
- 5) Open the water cock to start supplying water.
- 6) Turn on the main switch to restart the drill motor.

### 8.2.4 Stop drilling

#### WARNING

**Do not let the water and/or concrete slurry splash on the drill motor, cable, plug, and the power supply.**

Follow the procedure below.

- 1) When the core bit reaches the desired depth, turn the feed handle backwards to pull out the core bit from the surface of the drilling object.

- 2) Tighten the stopper-knob to fix the carriage block on the column.
- 3) Turn off the main switch to stop the drill motor.
- 4) Close the water cock to stop water supply.
- 5) Unplug the drill motor, and then remove the core bit from the spindle.
- 6) Loosen the stopper-knob, and turn the feed handle to pull up the carriage block until the upper end of the column.
- 7) Lift up and remove the drill motor with the carriage block from the column.
- 8) Remove the drill stand from the surface of the drilling object.

#### 8.2.5 Remove cores with the core removal lasso

##### **⚠ WARNING**

- **The core removal lasso is designed for concrete core removal purpose only. Never use it for any other purposes.**
- **Even though this tool has enough wire length to pull up 250 mm (10") diameter cores, the maximum applicable core size depends on the weight and length of the core, and situations.**

Follow the procedure shown in the illustration below.

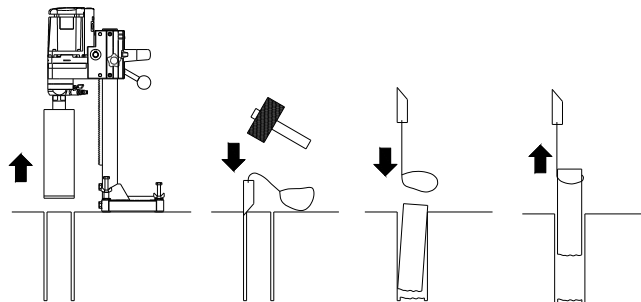

#### 8.2.6 Use of the swivel top (Option) for deep drilling

##### **⚠ CAUTION**

**The swivel top is only intended to use for swiveling the drill motor with the carriage block to facilitate core bit replacement and/or core removal operations. Do not use the swivel top part for drilling purpose. Drilling operation must be carried out by feeding the carriage block on the column.**

##### **NOTE**

Only adjust the carriage block when it is on the column. Adjusting the carriage block on the swivel top will cause difficulty in feeding the motor.

Follow the procedure below.

- 1) Refer to 8.2.1 Start drilling on page 19.
- 2) When the core bit reaches the desired depth, turn the feed handle backwards to pull out the core bit from the surface of the drilling object. Fix the carriage block on the column, stop the drill motor and water supply by referring to the procedure from 1) to 4) in 8.2.4 Stop drilling on page 19.
- 3) Unplug the drill motor, and then loosen the stopper-knob and pull up the carriage block to the swivel top.
- 4) Tighten the stopper-knob to fix the carriage block on the swivel top.
- 5) Rotate the drill motor with the carriage block while they are at the swivel top. If it rotates by its own weight or does not rotate at all, readjust the tightening torque of the nuts. (Fig.1) Refer to the procedure 6) to 7) in 7.5 Attaching the swivel top to the swivel top column (Option) on page 16.
- 6) After the core bit is replaced and/or the core is removed, rotate the drill motor with the carriage block back to the original position.
- 7) Loosen the stopper-knob and feed the carriage block from the swivel top to the column.
- 8) Tighten the stopper-knob to fix the carriage block on the column.
- 9) For restarting, refer to 8.2.1 Start drilling on page 19.

Fig.1

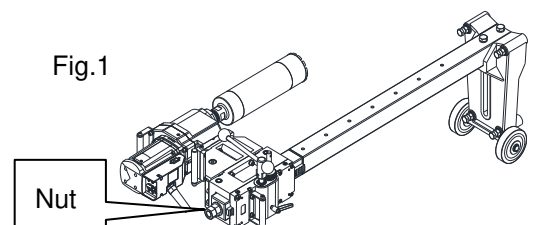

## 9. CLEANING

### WARNING

- Always disconnect the drill motor from power supply before starting any maintenance, cleaning, and inspection.
- Never immerse the drill motor in water or any other kind of liquid. It may cause electric shocks to the operator and others, and short circuit of the motor.

Cleaning procedure is following.

- 1) Ensure that the drill motor is unplugged from power supply, before start cleaning.
- 2) Wipe off each part of the drill motor with a wet towel which was tightly wrung.
- 3) Wipe off each part of the drill stand with a wet towel.
- 4) Wash away concrete slurry stuck on the base, the leveling bolts, and the column.
- 5) Rub each part of the machine with a dry cloth.

## 10. ACCESSORIES (OPTION)

Following items are available as optional accessories.

- 1 : Water Tank
- 2 : Water collection rings and fixtures
- 3 : 100 mm Spacer

## 11. MAINTENANCE

### **⚠ WARNING**

- Make sure the drill motor is switched off and disconnected from the power supply.
- Use only genuine Shibuya spare parts for the maintenance written in this manual.
- Repairs excluding the maintenance written in this manual must be carried out by qualified, skilled personnel. The safety of the power tool can thus be maintained.

### 11.1 Replacing the carbon brushes

Inspect the remaining length of the carbon brushes every 100 operating hours. If the carbon brushes are worn down to 7 mm or less, replace them with new carbon brushes. Ensure to replace both sides of carbon brushes as a pair.

#### **NOTE**

Always replace both carbon brushes as a pair. Use Shibuya genuine carbon brushes (carbon brush: 049626).

Follow the procedure below.

- 1) Loosen the screw on the brush cover with a Phillips screwdriver, and remove the brush cover.
- 2) Pull out the fasten terminal of the carbon brush from the brush holder with a flat-blade screwdriver.
- 3) Pick up the spring, and pull out the carbon brush while holding the spring with your fingers.
- 4) Insert a carbon brush into the brush holder.
- 5) Release the spring to hold the center of the carbon brush.
- 6) Connect the fasten terminal to the brush holder.
- 7) Fix the brush cover with the screw. Pay attention not to pinch the lead wire with the brush cover.

Loosen the screw



Remove the brush cover

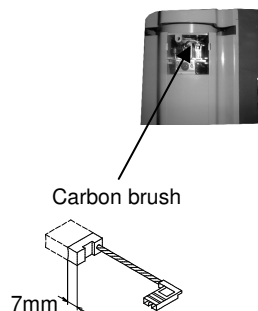

Take out the carbon brush

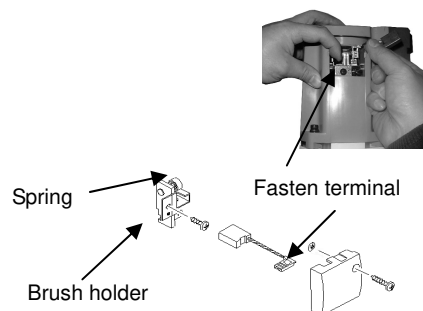

## 12. TRANSPORT AND STORAGE

### **⚠ WARNING**

Store the machine in a lockable area. Keep out of reach of children and unauthorized persons.

#### **NOTE**

- Never store the machine at the place where the ambient temperature is below 0 degrees C (32 degrees F) or above 40 degrees C (104 degrees F). Also, never store the machine where the ambient pressure is below 80 kPa (12 psi). Store the machine in dry conditions.
- Keep the feed handle and the grip handle dry, clean, and free from oil and grease.
- Transport the drill motor, the drill stand and the core bit as separate units. Hold the drill motor (with carriage block) tightly by the grip handle.



# 13. TROUBLESHOOTING

Trouble	What to do first	Possible Causes	Countermeasures	
The drill motor does not start.	(1) Turn off the main switch. (2) Turn off the PRCD (220-240V) and unplug the drill motor from the power supply.	Fault in the electric supply	Plug the drill motor into another power supply and check whether the drill motor works. Check the extension cord, RCD/GFCI/PRCD, power supply, and the outlet. Replace them if necessary.	
		Other power tools are plugged into the power supply.	Disconnect the other power tools from the power supply. Secure at least 5.2 kVA for the drill motor.	
		The power cable/plug is damaged.	Contact a Shibuya authorized dealer.	
		The main switch is damaged.	Contact a Shibuya authorized dealer.	
		The armature/field coil is damaged.	Contact a Shibuya authorized dealer.	
	The carbon brushes are worn out.	Replace the carbon brushes.		
The motor runs, but the core bit does not revolve well / abnormal noises.	(1) Turn off the main switch. (2) Turn off the PRCD (220-240V) and unplug the drill motor from the power supply. (3) Check that the gear change knob is shifted properly. (4) Check the core bit.	The gear change knob is not shifted properly.	Shift the gear change knob to engage gears properly.	
		The clutch is worn or loose.	Contact a Shibuya authorized dealer.	
		Gears are worn or damaged.	Contact a Shibuya authorized dealer.	
		Fragments of working materials such as rebar, concrete, stones are jammed between the core bit and the drilled material.	Remove the concrete core from the core bit.	
	(1) Check whether the circuit protector tripped.	If the circuit protector tripped, the drill motor was overloaded due to apply too much feed pressure.	Restart the drilling, and take care not to apply too much feed pressure.	
The drill motor shuts off during the operation.	(2) Check whether the PRCD tripped (220-240V).	If the PRCD tripped, electric leakage was detected or voltage was dropped.	Contact a Shibuya authorized dealer, or an electrical engineer.	
	(3) Unplug the drill motor from the power supply.	Electric power failure	Check the electric supply with electrical engineer.	
	Water leaks from the water leakage hole / swivel ring / spindle shaft.	(1) Turn off the main switch. (2) Turn off the PRCD (220-240V) and unplug the drill motor from the power supply. <b>DO NOT TOUCH THE POWER PLUG WITH WET HANDS.</b>	Oil seals are worn.	Contact a Shibuya authorized dealer.
Water pressure is too high.			Reduce the water pressure to less than 3 bar.	
The core bit can not be attached to the spindle.	(1) Check the core bit threads and the spindle threads.	The core bit thread is blocked with dirt or damaged.	Clean the thread, or replace the bit if necessary.	
		The spindle thread is blocked with dirt or damaged.	Clean the thread. If the spindle was damaged, contact a Shibuya authorized dealer.	
Drilling performance goes down	(1) Turn off the main switch. (2) Turn off the PRCD (220-240V) and unplug the drill motor from the power supply. (3) Check the drainage water from the drilling hole.	If the water contains iron powders, the machine is cutting the rebar(s).	Restart the drilling, and take care not to apply too much feeding pressure.	
		(4) Check the water supply	Insufficient coolant water	Increase the amount of water supply.
		(5) Check the core bit.	The core bit is worn out, damaged, or defected.	Replace with a new core bit.
	The core bit segments are glazed.		Contact the core bit seller to ask proper sharpening methods.	
	Aggregate of concrete is too hard.		Use a core bit with softer segments.	
	Maximum drilling depth is reached.		Remove the core and use an extension bar for core bits.	
	(6) Jolt the drill motor / stand / core bit to see if it shakes.	The base is not securely fixed to the working material.	Set up the machine again. Redo anchoring securely / Adjust the leveling bolts properly.	
		There is play between the carriage block and the column.	Adjust the carriage block.	
		Screws which are fastening the base and column, the carriage block and motor are loosened.	Tighten the screws.	
	(7) Check for the axial runout of the spindle.	Axial runout of the spindle is observed.	Contact a Shibuya authorized dealer.	

## 14. DISPOSAL



Do not dispose of this machine with domestic waste. Follow your national law.

With regard to environmental aspects, allowing drilling slurry to flow directly into rivers, lakes or the sewerage system without suitable pre-treatment is problematical. Ask your local authorities for applicable regulations.

## 15. LIMITED WARRANTY

Every Shibuya product is thoroughly inspected and tested before leaving the factory. Should any trouble develop, return the complete machine prepaid to your nearest Shibuya authorized dealer. If inspection shows the trouble is caused by defective workmanship or material, all repairs will be made without charge and the machine will be returned.

This warranty does not apply where;

- 1) Repairs or attempted repairs have been made by persons other than Shibuya authorized dealer.
- 2) Repairs are required because of normal wear.
- 3) The machine has been involved in an accident.
- 4) The machine has been misused.
- 5) The machine has been used after partial failure or normal wear.
- 6) The machine has been modified or used with improper accessories
- 7) The machine expires its warranty period of 1 year upon receipt of the machine.

No other warranty, written or verbal is authorized.

# 16. DIMENSIONS

Unit: mm [inch]

TS-405 with H2221 / H2231

TS-405(AB61) with H2221 / H2231

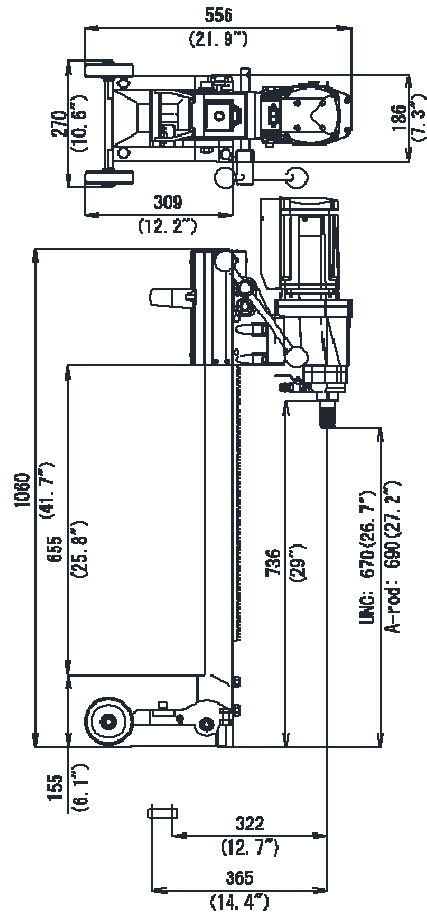
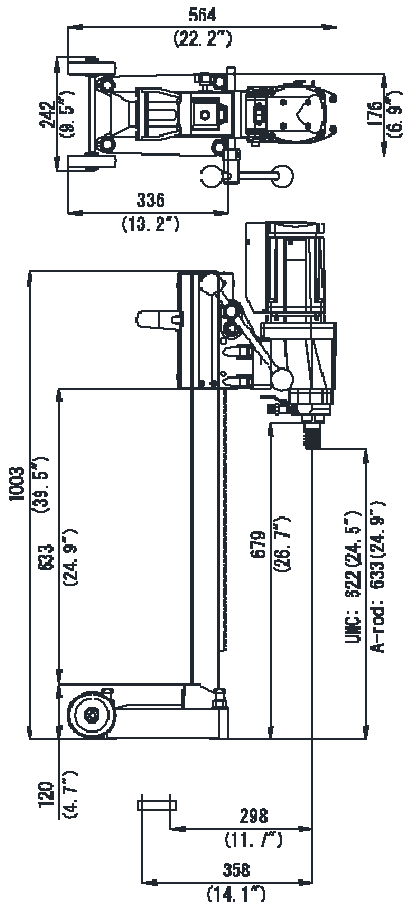

AB61

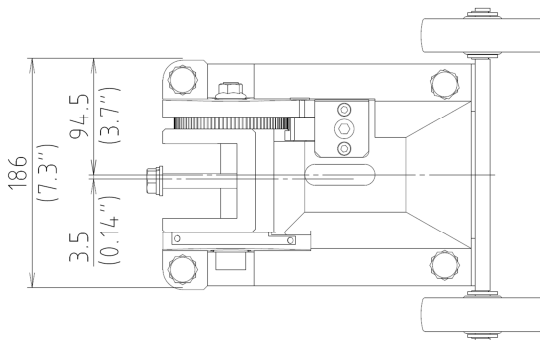

NOTE: The center of the column is offset 3.5 mm (0.14") away from the center of the anchor slot.

# 17. PARTS LISTS

## H2221 DRILL MOTOR (220-240 V)

H2221  
120V  
220-240V  
2022-12

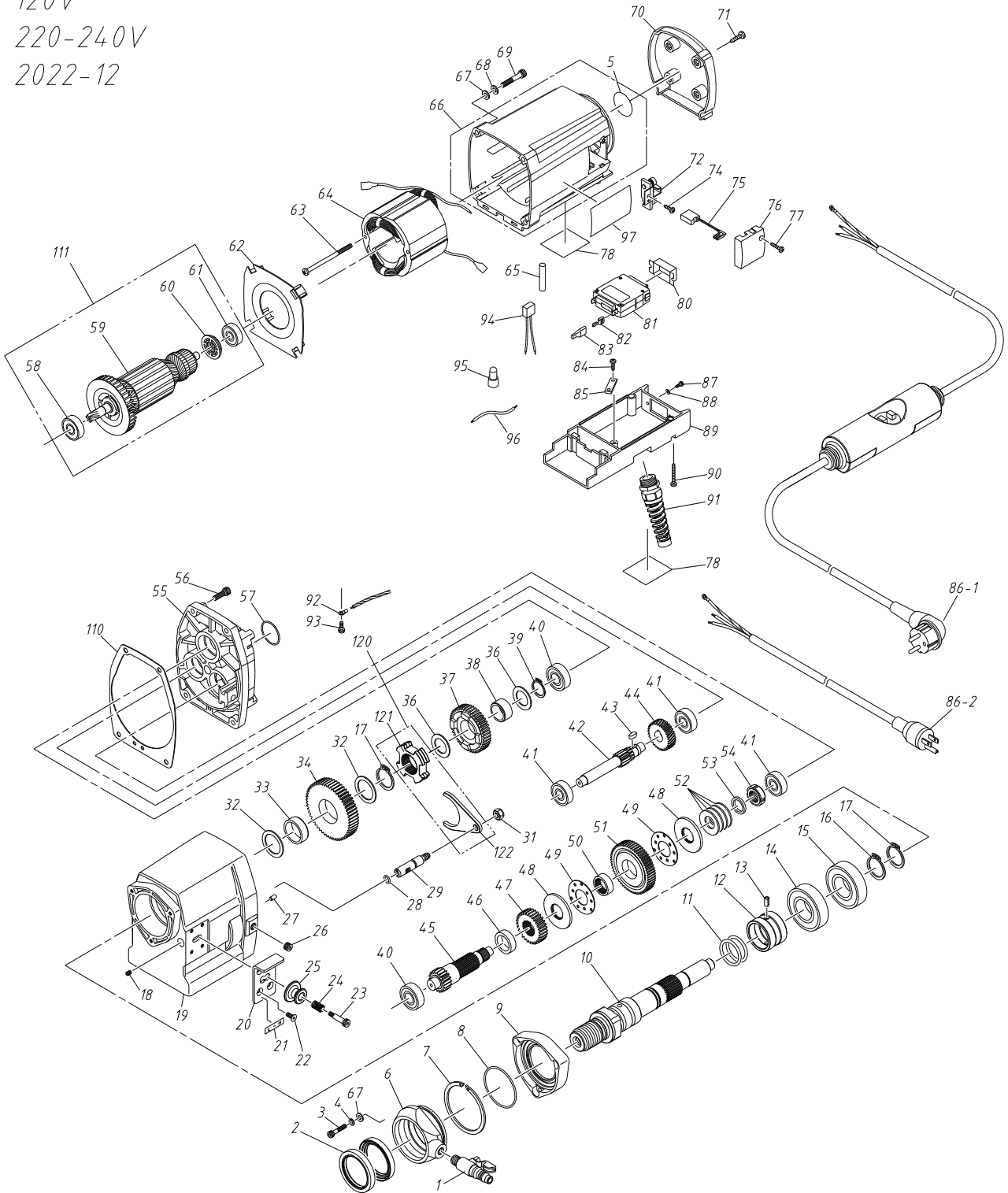

## H2221 DRILL MOTOR

POS	PART NAME	NOTE	QTY	CPT CODE
1	WATER COCK-SHIBUYA	1/4-φ16	1	000061
2	OIL SEAL	HMSA45609 (SUS)	2	043048
3	HEX. SOCKET BOLT	M5 × 30	3	043049
4	SPRING WASHER	5	3	042180
5	DUSTPROOF SEAL		1	052033
6	SWIVEL RING		1	052612
7	SNAP RING	SA70	1	005081
8	O-RING	S56	1	005080
9	FIXING RING		1	052613
10	SPINDLE (A)		1	043052
11	O-RING	P31	2	000151
12	SEAL RING		1	000152
13	SPRING PIN	6 × 12AW (SUS)	1	000004
14	BALL BEARING	6206DDU	1	000153
15	BALL BEARING	6206ZZ	1	043054
16	SNAP RING-C	30	1	000257
17	SNAP RING-C	29	2	000165
18	HEX. SOCKET SCREW	M5 × 6	1	000447
19	GEAR CASE		1	052608
20	PLATE		1	043057
21	SHIFT POSITION STICKER		1	042186
22	HEX. SOCKET SCREW	M5 × 12 COUNTERSUNK	4	006508
23	STRIPPER BOLT	MSB6.5-20	1	006509
24	COIL SPRING		1	000171
25	KNOB		1	043060
26	HEX. SOCKET PLUG	1/8	1	005386
27	PARALLEL PIN	A5 × 10	1	006559
28	O-RING	P9	1	005387
29	GEAR CHANGE SHAFT		1	006511
31	U-NUT	M8	1	000261
32	SHIM RING		2	006522
33	METAL		1	006523
34	NO. 8 GEAR		1	052611
36	SHIM RING		2	006526
37	NO. 6 GEAR		1	043099
38	METAL		1	006528
39	SNAP RING-C	22	1	006529
40	BALL BEARING	6202ZZ	2	000300
41	BALL BEARING	6201ZZ	3	000028
42	NO. 3 GEAR		1	043100
43	PARALLEL KEY	5 × 5 × 12	1	042872
44	NO. 2 GEAR		1	042734
45	NO. 7 GEAR		1	052610
46	RING		1	006514
47	NO. 5 GEAR		1	043139
48	CLUTCH		2	043074
49	WASHER		2	043073
50	METAL		1	042739
51	NO. 4 GEAR		1	043102
52	SPRING PLATE	MDS18-2	4	000014
53	RING		1	006520
54	TWIN FU NUT	TFU03SC	1	041776
55	BALL BEARING COVER		1	052609
56	HEX. SOCKET BOLT	M6 × 20	4	043104

POS	PART NAME	NOTE	QTY	CPT CODE
57	O-RING	S32	1	005389
58	BALL BEARING	6201HP	1	045618
59-1	ARMATURE 220-240V		1	
59-2	ARMATURE 110-120V		1	
60	COLLAR		1	042152
61	BALL BEARING	6200DDW	1	045620
62	FAN CASING		1	043080
63	TAPPING SCREW PANHEAD	5 × 85	2	043081
64-1	FIELD COIL 220-240V		1	052595
64-2	FIELD COIL 110-120V		1	053067
65	INSULATION TUBE	φ8 × 40	1	042174
66	MOTOR HOUSING W/DUSTPROOF SEAL		1	051948
67	WASHER	ROUND 6	7	042157
68	SPRING WASHER	2-6	4	042158
69	HEX. SOCKET BOLT	M6 × 35	4	043540
70	TAIL COVER		1	051949
71	TAPPING SCREW PANHEAD	5 × 20	4	042161
72	BRUSH HOLDER		2	042162
74	SCREW TRUSS PC	4 × 14	2	042163
75	CARBON BRUSH		2	049626
76	BRUSH COVER		2	051929
77	TAPPING SCREW PANHEAD	4 × 20	2	042166
78-1	MOTOR NAME PLATE 220-240V		2	
78-2	MOTOR NAME PLATE 120V		2	
80	DUST COVER	NRAR	1	000131
81-1	CIRCUIT PROTECTOR 220-240V	NRAR1100-15AAA	1	001944
81-2	CIRCUIT PROTECTOR 120V	NRAR1100-30AAA	1	044977
82	FASTEN TERMINAL		2	000057
83	CAP		2	000056
84	TAPPING SCREW PANHEAD	4 × 16	2	005495
85	CORD FIXER		1	042177
86-1	PLUG WITH CABLE & PRCD	220-240V EU/ASIA	1	042218
86-2	PLUG WITH CABLE	120V TW	1	045969
87	SCREW PANHEAD W/SW	M3 × 8	2	043093
88	WASHER	3	2	043094
89	SWITCH BOX		1	043492
90	SCREW PANHEAD B TIGHT	4 × 30	2	042171
91	CABLE SLEEVE		1	052825
92-1	TERMINAL w/ INSULATION	FVD2-M4 / 220-240V	1	045679
92-2	TERMINAL w/ INSULATION	FV5.5-S4 / 120V TW	1	043096
93	SCREW PANHEAD w/SW	M4 × 8	1	000706
94	CONDENSER	0.1 μF/220-240V	1	000059
95-1	CLOSED-END CONNECTOR	5.5SD / 220-240V	2	000055
95-2	CLOSED-END CONNECTOR	5.5SD / 120V TW	3	000055
96-1	LEAD WIRE	220-240V	1	043135
96-2	LEAD WIRE	120V TW	2	043097
97	LABEL		1	052180
110	RUBBER GASKET		1	044920
111-1	ARMATURE ASSY 220-240V	58+59+60+61	1	052594
111-2	ARMATURE ASSY 110-120V	58+59+60+61	1	048208
120	CLUTCH NO.3 WITH LEVER		1	048823
121	CLUTCH NO.3	AVAILABLE AS POS.#120 CODE #048823		
122	LEVER	CLUTCH NO.3 WITH LEVER		

# H2231 DRILL MOTOR

H2231 110-120V  
220-240V

2019-5

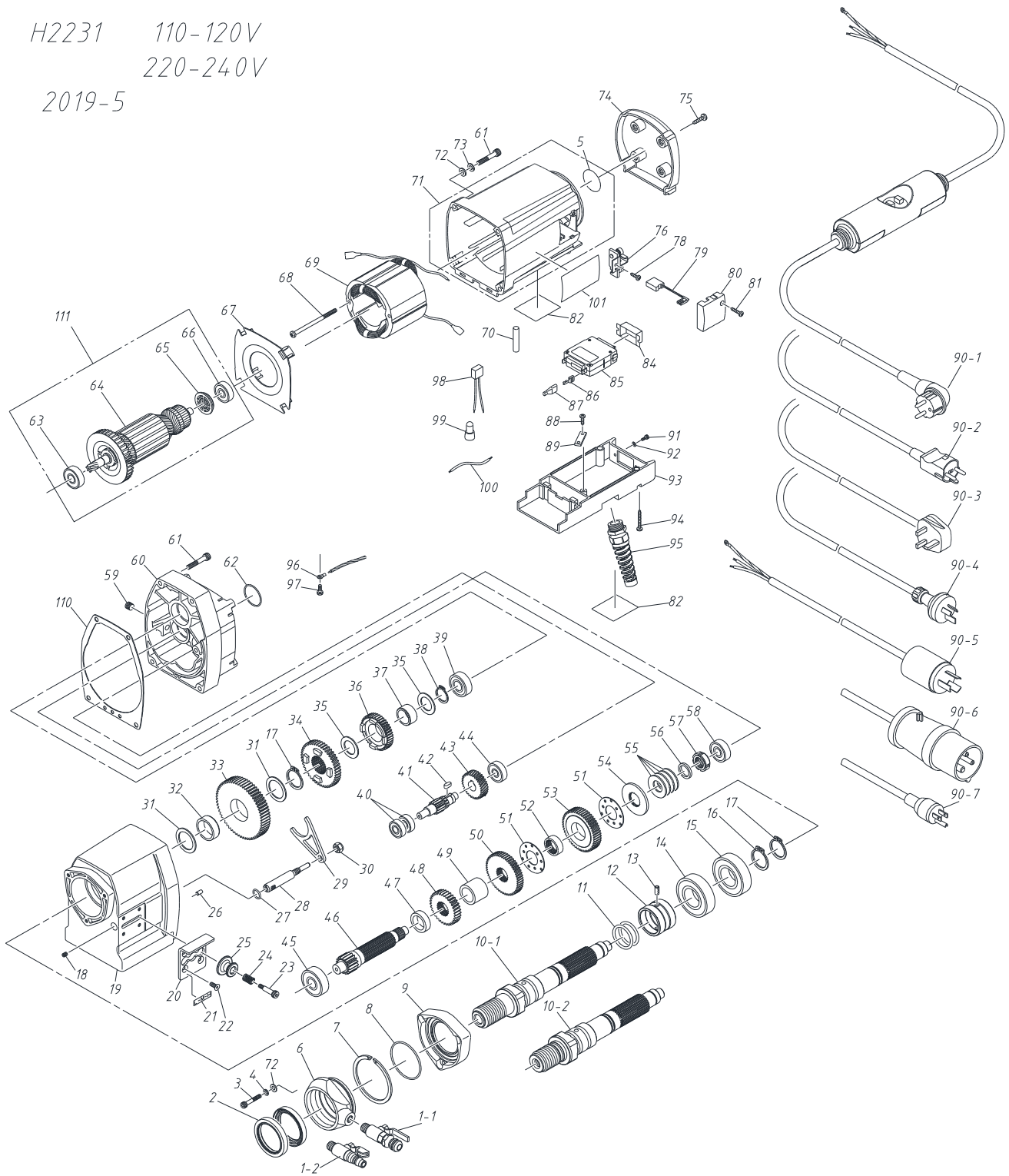

## H2231 DRILL MOTOR

POS	PART NAME	NOTE	QTY	CPT CODE
1-1	WATER COCK-GARDENA		1	044137
1-2	WATER COCK-SHIBUYA	1/4-φ16	1	000061
2	OIL SEAL	HMSA45609 (SUS)	2	043048
3	HEX. SOCKET BOLT	M5×30	3	043049
4	SPRING WASHER	5	3	042180
5	DUSTPROOF SEAL		1	052033
6	SWIVEL RING		1	052612
7	SNAP RING	SA70	1	005081
8	O-RING	S56	1	005080
9	FIXING RING		1	052613
10-1	SPINDLE (U)		1	043118
10-2	SPINDLE (A)		1	043053
11	O-RING	P31	2	000151
12	SEAL RING		1	000152
13	SPRING PIN	6×12AW (SUS)	1	000004
14	BALL BEARING	6206DDU	1	000153
15	BALL BEARING	6206ZZ	1	043054
16	SNAP RING-C	30	1	000257
17	SNAP RING-C	29	2	000165
18	HEX. SOCKET SCREW	M5×6	1	000447
19	GEAR CASE		1	051910
20	PLATE		1	043058
21	SHIFT POSITION STICKER		1	043059
22	HEX. SOCKET SCREW	M5×12 COUNTERSUNK	4	006508
23	STRIPPER BOLT	MSB6.5-20	1	006509
24	COIL SPRING		1	000171
25	KNOB		1	043061
26	PARALLEL PIN	A5×10	1	006559
27	O-RING	P12	1	053480
28	GEAR CHANGE SHAFT		1	052646
29	LEVER		1	043064
30	U-NUT	M8	1	000261
31	SHIM RING		2	006522
32	METAL		1	006523
33	NO. 10 GEAR		1	052645
34	NO. 8 GEAR		1	052643
35	SHIM RING		2	006526
36	NO. 6 GEAR		1	043067
37	METAL		1	006528
38	SNAP RING-C	22	1	006529
39	BALL BEARING	6202ZZ	1	000300
40	BALL BEARING	6000ZZ	2	000112
41	NO. 3 GEAR		1	043068
42	PARALLEL KEY	5×5×12	1	042872
43	NO. 2 GEAR		1	042734
44	BALL BEARING	6200ZZ	1	000030
45	BALL BEARING	6302ZZ	1	000325
46	NO. 9 GEAR		1	052644
47	RING		1	006514
48	NO. 7 GEAR		1	052642
49	RING		1	043071
50	NO. 5 GEAR		1	043072
51	WASHER		2	043073
52	METAL		1	042739
53	NO. 4 GEAR		1	043075
54	CLUTCH		1	043074
55	SPRING PLATE	MDS18-2	4	000014
56	RING		1	006520
57	TWIN FU NUT	TFU03SC	1	041776
58	BALL BEARING	6201ZZ	1	000028

POS	PART NAME	NOTE	QTY	CPT CODE
59	HEX. SOCKET PLUG	1/8	1	005386
60	BALL BEARING COVER		1	052641
61	HEX. SOCKET BOLT	M6×35	8	043540
62	O-RING	S32	1	005389
63	BALL BEARING	6201HP	1	045618
64-1	ARMATURE 110-120V		1	
64-2	ARMATURE 220-240V		1	
65	COLLAR		1	042152
66	BALL BEARING	6200DDW	1	045620
67	FAN CASING		1	043080
68	TAPPING SCREW PANHEAD	5×85	2	043081
69-1	FIELD COIL 110-120V		1	053067
69-2	FIELD COIL 220-240V		1	052595
70	INSULATION TUBE	φ8×40	1	042174
71	MOTOR HOUSING W/DUSTPROOF SEAL		1	051948
72	WASHER	ROUND 6	7	042157
73	SPRING WASHER	2-6	4	042158
74	TAIL COVER		1	051949
75	TAPPING SCREW PANHEAD	5×20	4	042161
76	BRUSH HOLDER		2	042162
78	SCREW TRUSS PC	4×14	2	042163
79	CARBON BRUSH		2	049826
80	BRUSH COVER		2	051929
81	TAPPING SCREW PANHEAD	4×20	2	042166
82	MOTOR NAME PLATE		2	
84	DUST COVER	NRAR	1	000131
85-1	CIRCUIT PROTECTOR 110-120V	NRAR1100-30ADA	1	044977
85-2	CIRCUIT PROTECTOR 220-240V	NRAR1100-15AAA	1	001944
86	FASTEN TERMINAL		2	000057
87	CAP		2	000056
88	TAPPING SCREW PANHEAD	4×16	2	005495
89-1	CORD FIXER 220-240V		1	042177
89-2	CORD FIXER 110-120V		1	044747
90-1	PLUG WITH CABLE & PRCD	220-240V EU/ASIA	1	042218
90-2	PLUG WITH CABLE & PRCD	220-240V DK	1	042783
90-3	PLUG WITH CABLE & PRCD	220-240V SA	1	050972
90-4	PLUG WITH CABLE & PRCD	220-240V AU	1	051170
90-5	PLUG WITH CABLE	110-120V US	1	043121
90-6	PLUG WITH CABLE	110V UK	1	053048
90-7	PLUG WITH CABLE	110-120V TW	1	045969
91	SCREW PANHEAD W/SW	M3×8	2	043093
92	WASHER	3	2	043094
93	SWITCH BOX		1	043492
94	SCREW PANHEAD B TIGHT	4×30	2	042171
95	CABLE SLEEVE		1	052825
96-1	TERMINAL w/ INSULATION	FVD2-M4 / 220-240V AND UK	1	045679
96-2	TERMINAL w/ INSULATION	FV5.5-S4 / 110-120V US/TW	1	043096
97	SCREW PANHEAD w/SW	M4×8	1	000706
98-1	CONDENSER	0.1μF/220-240V	1	000059
98-2	CONDENSER	0.1μF/110V UK	2	000059
99-1	CLOSED-END CONNECTOR	5.5SD / 220-240V	2	000055
99-2	CLOSED-END CONNECTOR	5.5SD / 110-120V US TW	3	000055
99-3	CLOSED-END CONNECTOR	5.5SD / 110V UK	2	000055
100-1	LEAD WIRE	220-240V	1	043135
100-2	LEAD WIRE	110-120V US TW	2	043097
100-3	LEAD WIRE	110V UK	1	043097
101	LABEL		1	052180
110	RUBBER GASKET		1	044922
111-1	ARMATURE ASSY 110-120V	63+64+65+66	1	048208
111-2	ARMATURE ASSY 220-240V	63+64+65+66	1	052594

# CARRIAGE BLOCK FOR H2221/H2231

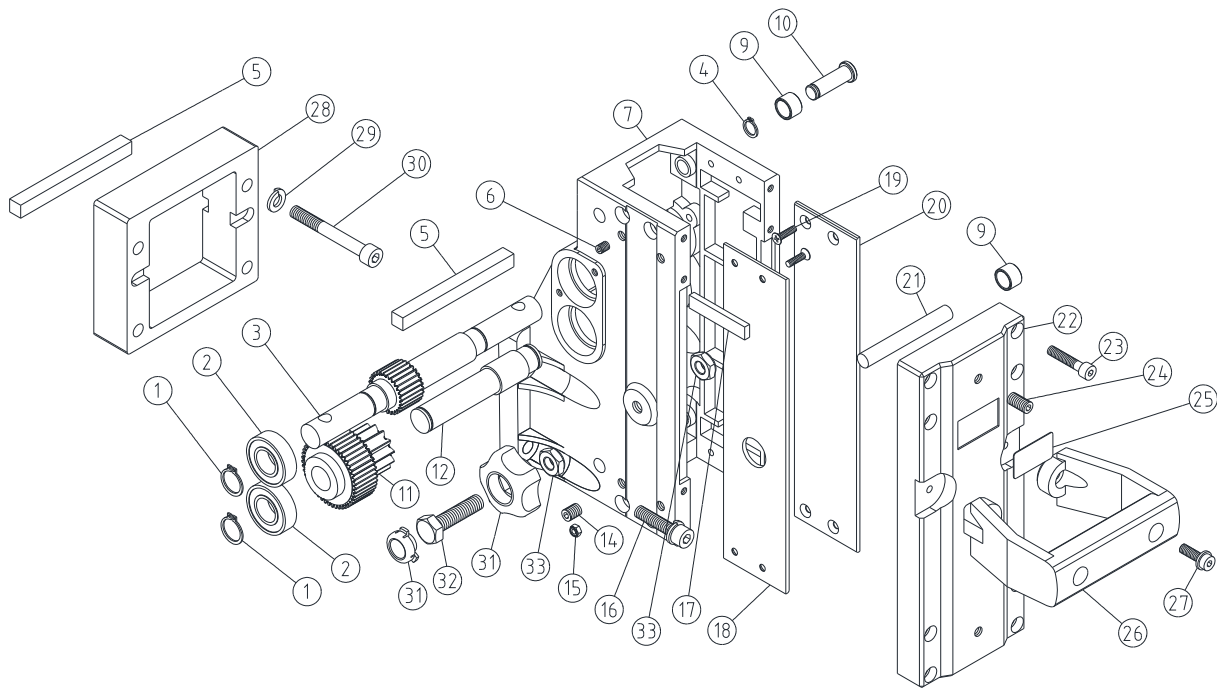

POS	PART NAME	NOTE	QTY	CPT CODE
1	SNAP RING-C	17	4	000272
2	BALL BEARING	6003-2VU	4	048379
3	PINION GEAR		1	000568
4	SNAP RING-C	10	4	041411
5	PARALLEL KEY	10 × 10 × 100	2	042952
6	HEX. SOCKET SCREW	M6 × 12	4	042123
7	CARRIAGE BODY		1	052738
9	ROLLER WITH BUSH		8	049273
10	ROLLER SHAFT (F)		4	052005
11	REDUCTION NO.2-3 GEAR w/COLLAR		1	000535
12	NO.2-3 GEAR SHAFT		1	000534
14	HEX. SOCKET SCREW	M8 × 10	4	004655
15	NYLON NUT	M4	8	000481
16	HEX. SOCKET BOLT w/SW	M8 × 35	4	042392
17	PLATE		2	000531
18	ADJUSTMENT PLATE-2		1	006496
19	SCREW COUNTERSUNK	M4 × 16	8	000515
20	ADJUSTMENT PLATE-1		1	006495
21	ROLLER SHAFT (R)		2	042955
22	BACK COVER		1	042949
23	HEX. SOCKET BOLT	M6 × 30	8	042957
24	HEX. SOCKET SCREW	M8 × 16	2	042956
25	LABEL		1	
26	GRIP HANDLE (RESIN)		1	042133
27	HEX. SOCKET BOLT FLANG	M6 × 18	2	042958
28	30MM SPACER BODY		1	052736
29	SPRING WASHER	2-8	4	042824
30	HEX. SOCKET BOLT	M8 × 65	4	042972
31	STOPPER-KNOB	M10	1	042268
32	HEX. BOLT	M10 × 40 (COPPER)	1	042267
33	U-NUT	3-M10	2	043045
	CARRIAGE BLOCK CPL.		1	053211
	30MM SPACER SET		1	052735



# QUICK RELEASE HANDLE

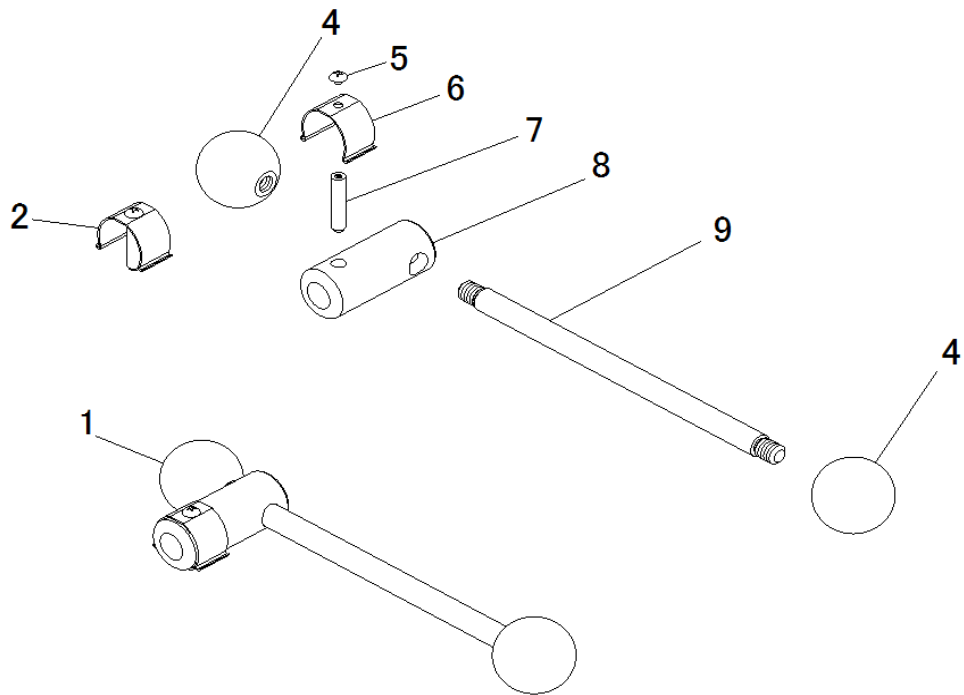

POS	PART NAME	NOTE	QTY	CPT CODE
1	Q.R.HANDLE CPL.		1	042959
2	RETAINER COMPLETE		1	006095
4	GRIP BALL DIA.45		2	042113
5	SCREW	M5 × 6(SUS)	1	006091
6	SPRING		1	006092
7	PIN		1	006093
8	HANDLE BODY		1	006094
9	HANDLE ROD		1	000492

# TS-405 BASE AND COLUMN 1000L

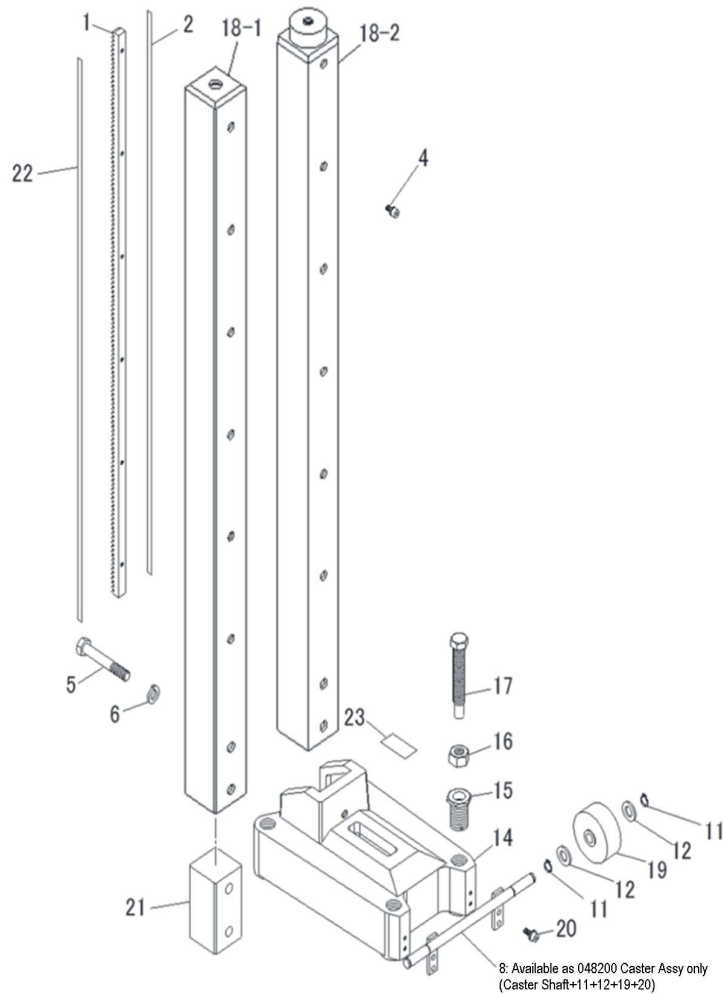

## COLUMN

POS	PART NAME	NOTE	QTY	CPT CODE
1	RACK GEAR		1	045571
2	DEPTH GAUGE DECAL (mm)		1	000520
4	HEX. SOCKET BOLT w/SW	M6 x 12	6	004672
18-1	COLUMN - STANDARD TYPE		1	043026
18-2	COLUMN w/SWIVEL TOP CONNECTION		1	042962
21	CORE BLOCK		1	006583
22	DEPTH GAUGE DECAL (inch)	US	1	044497
	COLUMN CPL. STANDARD TYPE		1	042976
	COLUMN CPL. STANDARD TYPE	US	1	051684
	COLUMN CPL. w/SWIVEL TOP CONNECTION		1	051686

## BASE

POS	PART NAME	NOTE	QTY	CPT CODE
5	HEX. BOLT	M12 x 80	2	042966
6	SPRING WASHER	2-12	2	042098
8	CASTER SHAFT	Available as 048200 Caster Assy only	1	N/A
11	SNAP RING-C	12	4	000456
12	PLAIN WASHER	12	4	042726
14	BASE PLATE		1	042964
15	HEX. BOSS	M16	4	042968
15	HEX. BOSS	5/8 (US)	4	044371
16	HEX. NUT	1-M16	4	042967
16	HEX. NUT	5/8-11UNC	4	044370
17	LEVELING BOLT	M16	4	042965
17	LEVELING BOLT	5/8	4	044369
19	WHEEL	425E-R100mm	2	000581
20	HEX. SOCKET BOLT w/SW	M6 x 15	2	045576
	TS-405 BASE ASSY		1	042975
	TS-405 BASE ASSY	US	1	053212
	CASTER ASSY	CASTER SHAFT+11+12+19+20	1	048200

# AB61 SWIVEL BASE

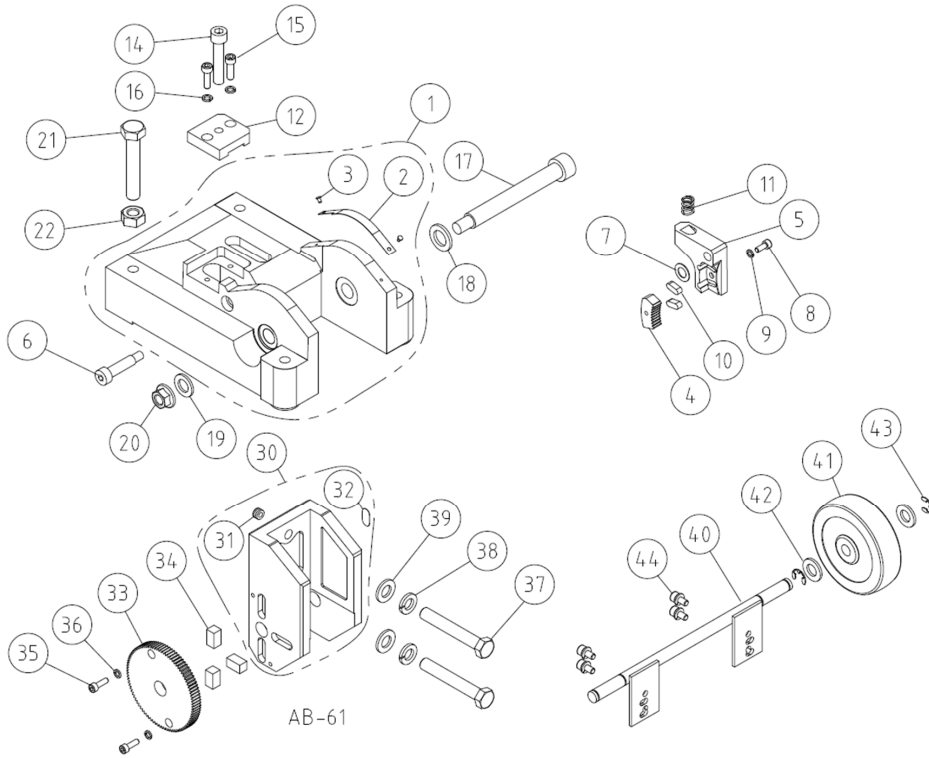

POS	PART NAME	NOTE	QTY	CPT CODE
1	BASE PLATE W/ANGLE SCALE		1	049290
2	ANGLE SCALE		1	000725
3	PIN	#4 × 4.8	2	000726
4	INTERNAL GEAR		1	000717
5	CLAMP		1	000719
6	SHOULDER BOLT	MSB10-35	1	000722
7	WASHER	MSR10-0.5	1	000716
8	HEX. SOCKET BOLT	M5 × 12	1	000169
9	SPRING WASHER	5	1	047911
10	KEY	6 × 6 × 16	2	000718
11	COIL SPRING		1	000462
12	PLATE		1	000715
14	HEX. SOCKET BOLT	M10 × 30	1	000713
15	HEX. SOCKET BOLT	M6 × 20	2	000308
16	SPRING WASHER	6	2	047912
17	SHOULDER BOLT	MSB16-120	1	000728
18	PLAIN WASHER	16	1	042100
19	PLAIN WASHER	12	1	042726
20	FLANGED NUT	M12	1	000723
21	HEX. BOLT	W1/2 × 75	4	000771
22	HEX. NUT	1-W1/2	4	042651
30	COLUMN HOLDER ASSY		1	049288
31	HELISERT	M12 × 1D	2	000610
32	INDICATION LABEL		1	000732
33	GEAR WHEEL		1	000729
34	KEY		3	000730
35	HEX. SOCKET BOLT	M5 × 15	2	000412
36	SPRING WASHER	5	2	047911
37	HEX. BOLT	M12 × 80	2	042966
38	SPRING WASHER	2-12	2	042098
39	PLAIN WASHER	12	2	042726
40	WHEEL SHAFT		1	042069
41	WHEEL	425E-R100mm	2	000581
42	PLAIN WASHER	12	4	042726
43	SNAP RING E	10	4	000580
44	HEX. SOCKET BOLT	M6 × 12 w/SW	4	047554
	AB61 SWIVEL BASE CPL.			041839

## EU DECLARATION OF CONFORMITY

SHIBUYA COMPANY, LTD.

5-86, MOKUZAIKO-KITA, HATSUKAICHI, HIROSHIMA 738-0021 JAPAN

declares, in sole responsibility, that the following equipment

Drill Stand Model TS-405 with H2231 Drill Motor (110 V), Country of Origin: Japan

Drill Stand Model TS-405(AB61) with H2231 Drill Motor (110 V), Country of Origin: Japan

Drill Stand Model TS-405 with H2231 Drill Motor (220-240 V), Country of Origin: Japan

Drill Stand Model TS-405(AB61) with H2231 Drill Motor (220-240 V), Country of Origin: Japan

Serial No.:

Referred to in this declaration conforms with the following directive(s):

**Machinery Directive 2006/42/EC**, Annex I, Annex IIA

Harmonized standards: EN 62841-1:2015, EN 62841-3-6:2014

EN ISO 12100:2010

**EMC Directive 2014/30/EU**

Harmonized standards: EN 55014-1:2006+A1:2009+A2:2011, EN 55014-2:1997+A1:2001+A2:2008

EN 61000-3-2:2014, EN 61000-3-3:2013, EN 61000-3-11:2000

**RoHS Directive 2011/65/EU**

Authorized representative / Importer in UK;

DYMATEC LTD

Units 11-14 Cemetery Road, Houghton Regis, Bedfordshire, LU5 5BZ, United Kingdom

Mr. Jeremy David Newton

The person authorized to compile the technical file;

Mr. Jeremy David Newton

Units 11-14 Cemetery Road, Houghton Regis, Bedfordshire, LU5 5BZ, United Kingdom

Note: This declaration becomes invalid if technical or operational modifications are introduced without the manufacturer's consent.

Hiroshima, 6/2019

Kazuyoshi Shibuya, Director

SHIBUYA COMPANY, LTD.

## UK DECLARATION OF CONFORMITY

SHIBUYA COMPANY, LTD.

5-86, MOKUZAIKO-KITA, HATSUKAICHI, HIROSHIMA 738-0021 JAPAN

declares, in sole responsibility, that the following equipment

Drill Stand Model TS-405 with H2231 Drill Motor (110 V), Country of Origin: Japan

Drill Stand Model TS-405(AB61) with H2231 Drill Motor (110 V), Country of Origin: Japan

Serial No.: 2240001 - UP

referred to in this declaration conforms with the following regulation (s):

The Supply of Machinery (Safety) Regulations 2008

Harmonized standards: EN 62841-1:2015, EN 62841-3-6:2014

EN ISO 12100:2010

The Electromagnetic Compatibility Regulations 2016

Harmonized standards: EN 55014-1:2006+A1:2009+A2:2011, EN 55014-2:1997+A1:2001+A2:2008

EN 61000-3-2:2014, EN 61000-3-3:2013, EN 61000-3-11:2000

The Restriction of the Use of Certain Hazardous Substances

in Electrical and Electronic Equipment Regulations 2012

Authorized representative / Importer in UK;

DYMATEC LTD

Units 11-14 Cemetery Road, Houghton Regis, Bedfordshire, LU5 5BZ, United Kingdom

Mr. Jeremy David Newton

The person authorized to compile the technical file;

Mr. Jeremy David Newton

Units 11-14 Cemetery Road, Houghton Regis, Bedfordshire, LU5 5BZ, United Kingdom

Note: This declaration becomes invalid if technical or operational modifications are introduced without the manufacturer's consent.

Hiroshima, 4/2022

Kazuyoshi Shibuya, President & CEO

SHIBUYA COMPANY, LTD.

## EU DECLARATION OF CONFORMITY

SHIBUYA COMPANY, LTD.

5-86, MOKUZAIKO-KITA, HATSUKAICHI, HIROSHIMA 738-0021 JAPAN

declares, in sole responsibility, that the following equipment

Drill Stand Model TS-405 with H2231 Drill Motor (110 V), Country of Origin: Japan

Drill Stand Model TS-405(AB61) with H2231 Drill Motor (110 V), Country of Origin: Japan

Drill Stand Model TS-405 with H2231 Drill Motor (220-240 V), Country of Origin: Japan

Drill Stand Model TS-405(AB61) with H2231 Drill Motor (220-240 V), Country of Origin: Japan

Serial No.:

Referred to in this declaration conforms with the following directive(s):

**Machinery Directive 2006/42/EC**, Annex I, Annex IIA

Harmonized standards: EN 62841-1:2015, EN 62841-3-6:2014

EN ISO 12100:2010

**EMC Directive 2014/30/EU**

Harmonized standards: EN 55014-1:2006+A1:2009+A2:2011, EN 55014-2:1997+A1:2001+A2:2008

EN 61000-3-2:2014, EN 61000-3-3:2013, EN 61000-3-11:2000

**RoHS Directive 2011/65/EU**

Authorized representative / Importer in UK;

DIAQUIP

Unit 1, Whitefield Road Ind. Est, Bredbury, Stockport SK6 SQR. United Kingdom

The person authorized to compile the technical file;

Mr. Jonathan Shaw

Unit 1, Whitefield Road Ind. Est, Bredbury, Stockport SK6 SQR. United Kingdom

Note: This declaration becomes invalid if technical or operational modifications are introduced without the manufacturer's consent.

Hiroshima, 6/2019

Kazuyoshi Shibuya, Director

SHIBUYA COMPANY, LTD.

## UK DECLARATION OF CONFORMITY

SHIBUYA COMPANY, LTD.

5-86, MOKUZAIKO-KITA, HATSUKAICHI, HIROSHIMA 738-0021 JAPAN

declares, in sole responsibility, that the following equipment

Drill Stand Model TS-405 with H2231 Drill Motor (110 V), Country of Origin: Japan

Drill Stand Model TS-405(AB61) with H2231 Drill Motor (110 V), Country of Origin: Japan

Serial No.: 2240001 - UP

referred to in this declaration conforms with the following regulation(s):

The Supply of Machinery (Safety) Regulations 2008

Harmonized standards: EN 62841-1:2015, EN 62841-3-6:2014

EN ISO 12100:2010

The Electromagnetic Compatibility Regulations 2016

Harmonized standards: EN 55014-1:2006+A1:2009+A2:2011, EN 55014-2:1997+A1:2001+A2:2008

EN 61000-3-2:2014, EN 61000-3-3:2013, EN 61000-3-11:2000

The Restriction of the Use of Certain Hazardous Substances

in Electrical and Electronic Equipment Regulations 2012

Authorized representative / Importer in UK;

DIAQUIP

Unit 1, Whitefield Road Ind. Est, Bredbury, Stockport SK6 SQR. United Kingdom

The person authorized to compile the technical file;

Mr. Jonathan Shaw

Unit 1, Whitefield Road Ind. Est, Bredbury, Stockport SK6 SQR. United Kingdom

Note: This declaration becomes invalid if technical or operational modifications are introduced without the manufacturer's consent.

Hiroshima, 4/2022

Kazuyoshi Shibuya, President & CEO

SHIBUYA COMPANY, LTD.

## DECLARATIE DE CONFORMITATE EU

SHIBUYA COMPANY, LTD.  
5-86, MOKUZAIKO-KITA, HATSUKAICHI, HIROSHIMA 738-0021 JAPAN  
declară pe proprie răspundere că următoarele echipamente :

Stand de carotare TS-405 cu Motor de carotare H2231 (220-240 V), tara de origine: Japonia  
Stand de carotare TS-405(AB61) cu Motor de carotare H2231 (220-240 V), tara de origine: Japonia

Seria Nr.:

Respecta urmatoarele directive europene:

Directiva **2006/42/EC**, Annex I, Annex IIA privind echipamentele tehnice

Standardele armonizate : EN 62841-1:2015, EN 62841-3-6:2014

EN ISO 12100:2010

Directiva EMC **2014/30/EU**

Standardele armonizate: EN 55014-1:2006+A1:2009+A2:2011, EN 55014-2:1997+A1:2001+A2:2008

EN 61000-3-2:2014, EN 61000-3-3:2013, EN 61000-3-11:2000

Directiva RoHS **2011/65/EU**

Reprezentant autorizat/Importator in Romania:

ANTREPRIZA CONTRACTON SRL  
STR. FRUMUSANI, NR. 12, BL. 100, SC.2, AP 63,  
SECTOR 4, BUCURESTI, ROMANIA  
MR. DANIEL TELER

Persoana autorizata sa intocmeasca fisa tehnica:

MR. DANIEL TELER  
STR. FRUMUSANI, NR. 12, BL. 100, SC.2, AP 63,  
SECTOR 4, BUCURESTI, ROMANIA

Nota: Această declarație devine nulă în cazul în care modificările tehnice sau operaționale sunt introduse fără acordul producătorului.

Hiroshima, 6/2019  
Kazuyoshi Shibuya, Director  
SHIBUYA COMPANY, LTD.



## UE – DEKLARACJA ZGODNOŚCI

SHIBUYA COMPANY, LTD.

5-86, MOKUZAIKO-KITA, HATSUKAICHI, HIROSHIMA 738-0021 JAPONIA

oświadcza, na własną i wyłączną odpowiedzialność, że następujący sprzęt:

Statyw wiertarki Model TS-405 z silnikiem H2231 (220-240 V), Kraj pochodzenia : Japonia

Statyw wiertarki Model TS-405(AB61) z silnikiem H2231 (220-240 V), Kraj pochodzenia : Japonia

Numer seryjny:

o którym mowa w niniejszej deklaracji spełnia następujące dyrektywy:

Dyrektywę Maszynową **2006/42/EC**, Annex I, Annex IIA

Ujednolicone normy: EN 62841-1:2015, EN 62841-3-6:2014

EN ISO 12100:2010

Dyrektywa dotyczy kompatybilności elektromagnetycznej **2014/30/EU**

Ujednolicone normy: EN 55014-1:2006+A1:2009+A2:2011, EN 55014-2:1997+A1:2001+A2:2008

EN 61000-3-2:2014, EN 61000-3-3:2013, EN 61000-3-11:2000

Dyrektywę RoHS **2011/65/EU**

Autoryzowany przedstawiciel / Importer w Polsce;

BETON-TECHNIK

Ul.28 Czewca 56r. Nr. 159/1, 61-505 Poznan, Polska

Osoba upoważniona do wykonania dokumentacji technicznej;

Pana Kazimierza Lewandowskiego

Ul.28 Czewca 56r. Nr. 159/1, 61-505 Poznan, Polska

Uwaga: Niniejsza deklaracja staje się nieważna jeśli bez zgody producenta wprowadzone zostały modyfikacje techniczne lub operacyjne.

Hiroshima, 6/2019

Kazuyoshi Shibuya, Dyrektor

SHIBUYA COMPANY, LTD.

## EU SAMSVARERKLÆRING

SHIBUYA COMPANY, LTD.  
5-86, MOKUZAIKO-KITA, HATSUKAICHI, HIROSHIMA 738-0021 JAPAN  
erklærer, på eget ansvar, at følgende utstyr:

Borstativ Modell TS-405 med H2231 motorenhet (220-240 V), Varens opprinnelsesland:Japan  
Borstativ Modell TS-405(AB61) med H2231 motorenhet (220-240 V), Varens opprinnelsesland:Japan

Serienummer:

Nevnt i denne erklæring er i samsvar med følgende direktiv(er)

Maskin direktiv **2006/42/EC**, Annex I, Annex IIA  
Harmonisert standard: EN 62841-1:2015, EN 62841-3-6:2014  
EN ISO 12100:2010

EMC Direktiv **2014/30/EU**  
Harmonisert standard: EN 55014-1:2006+A1:2009+A2:2011, EN 55014-2:1997+A1:2001+A2:2008  
EN 61000-3-2:2014, EN 61000-3-3:2013, EN 61000-3-11:2000

RoHS Direktiv **2011/65/EU**

Importør i Norge

LEVANTO NORGE AS  
PER KROHGS VEI 4C  
1065 OSLO  
NORWAY  
MR. PATRICK SANDMAN  
TLF : +47 22 90 61 50

Personen som er autorisert til å samle og dokumentere teknisk informasjon;

LEVANTO OY  
Venevalkamantie 5, 02700 Kauniainen, Finland J

Merk: Denne deklarasjonen blir ugyldig om tekniske eller operasjonelle modifikasjoner blir utført uten produsentens tillatelse.

Hiroshima, 6/2019  
Kazuyoshi Shibuya, Direktør  
SHIBUYA COMPANY, LTD.

## EU OVERENSSTEMMELSESERKLÆRING

SHIBUYA COMPANY, LTD.  
5-86, MOKUZAIKO-KITA, HATSUKAICHI, HIROSHIMA 738-0021 JAPAN  
Erklærer hermed, under eget ansvar, at det følgende udstyr

Borestander Model TS-405 med H2231 Boremotor (220-240 V), Oprindelsesland : Japan  
Borestander Model TS-405(AB61) med H2231 Boremotor (220-240 V), Oprindelsesland : Japan

Serienummer:

Henvist til I denne erklæring, er I overensstemmelse med retningslinjerne I nedennævnte direktiver:

**Maskindirektiv 2006/42/EC**, Annex I, Annex IIA

Harmoniserede standarder: EN 62841-1:2015, EN 62841-3-6:2014

EN ISO 12100:2010

**EMC-direktiv 2014/30/EU**

Harmoniserede standarder: EN 55014-1:2006+A1:2009+A2:2011, EN 55014-2:1997+A1:2001+A2:2008

EN 61000-3-2:2014, EN 61000-3-3:2013, EN 61000-3-11:2000

**RoHS-direktiv 2011/65/EU**

Autoriseret repræsentant/forhandler og importør i DANMARK;

J.D. Diamantværktøj A/S

Glentevej 33, DK-4600 Køge, Denmark

Personen der er autoriseret til udarbejde/oversætte den tekniske fil;

Teknisk ansvarlig: Mr. Hans Henrik Danielsen

Glentevej 33, DK-4600 Køge, Denmark

Note: Denne erklæring anses for værende ugyldig, såfremt der er foretaget tekniske eller operationelle modifikationer, uden producentens samtykke.

Hiroshima, 6/2019

Kazuyoshi Shibuya, Director

SHIBUYA COMPANY, LTD.

## EY-VAATIMUSTENMUKAISUUSVAKUUTUS

SHIBUYA COMPANY, LTD.  
5-86, MOKUZAIKO-KITA, HATSUKAICHI, HIROSHIMA 738-0021 JAPAN  
vakuuttaa omalla vastuullaan, että tässä vakuutuksessa mainitut laitteet:

Porakonejalusta, malli TS-405, H2231-moottorilla (220-240 V) varustettu porakone, alkuperämaa: Japani  
Porakonejalusta, malli TS-405(AB61), H2231-moottorilla (220-240 V) varustettu porakone, alkuperämaa: Japani

Sarja No.:

ovat seuraavan direktiivin (seuraavien direktiivien) mukaisia:

Konedirektiivi **2006/42/EC**, Annex I, Annex IIA

Yhdenmukaiset standardit: EN 62841-1:2015, EN 62841-3-6:2014  
EN ISO 12100:2010

EMC-direktiivi **2014/30/EU**

Yhdenmukaiset standardit: EN 55014-1:2006+A1:2009+A2:2011, EN 55014-2:1997+A1:2001+A2:2008  
EN 61000-3-2:2014, EN 61000-3-3:2013, EN 61000-3-11:2000

RoHS-direktiivi **2011/65/EU**

Valtuutettu edustaja Suomessa;

LEVANTO OY

Venevalkamantie 5, 02700 Kauniainen, Suomi

Teknillisten tiedostojen kääntämiseen valtuutettu henkilö;

Patrick Sandman

Venevalkamantie 5, 02700 Kauniainen, Suomi

Huomaa: Tämä vakuutus lakkaa olemasta voimassa, jos teknisiä tai käyttöön liittyviä muutoksia tehdään ilman valmistajan suostumusta.

Hiroshima, 6/2019

Kazuyoshi Shibuya, Toimitusjohtaja

SHIBUYA COMPANY, LTD.

## DÉCLARATION DE CONFORMITÉ EU

SHIBUYA COMPANY, LTD.

5-86, MOKUZAIKO-KITA, HATSUKAICHI, HIROSHIMA 738-0021 JAPAN

déclare sous sa seule responsabilité que les équipements suivants :

Bâti de carottage TS-405 avec moteur de carottage H2231 (220-240 V), Pays d'origine : Japon

Bâti de carottage TS-405(AB61) avec moteur de carottage H2231 (220-240 V), Pays d'origine : Japon

No de série:

Sont conformes aux directives européennes suivantes :

Directive Machines **2006/42/EC**, Annex I, Annex IIA

Normes harmonisées: EN 62841-1:2015, EN 62841-3-6:2014

EN ISO 12100:2010

Directive CEM **2014/30/EU**

Normes harmonisées: EN 55014-1:2006+A1:2009+A2:2011, EN 55014-2:1997+A1:2001+A2:2008

EN 61000-3-2:2014, EN 61000-3-3:2013, EN 61000-3-11:2000

Directive RoHS **2011/65/EU**

Représentant autorisé / Importateur en France;

PEUVREL OUTILS DIAMANTÉS

35 rue La Maison-Neuve, 35270 BONNEMAIN, FRANCE

La personne autorisée à compiler le dossier technique;

Mr. Julien Peuvrel

35 rue La Maison-Neuve, 35270 BONNEMAIN, FRANCE

Note: Cette déclaration devient invalide si des modifications techniques ont lieu sans l'accord du fabricant.

Hiroshima, 6/2019

Kazuyoshi Shibuya, Directeur

SHIBUYA COMPANY, LTD.

## EU SAMSVARERKLÆRING

SHIBUYA COMPANY, LTD.  
5-86, MOKUZAIKO-KITA, HATSUKAICHI, HIROSHIMA 738-0021 JAPAN  
erklærer, på eget ansvar, at følgende utstyr:

Borstativ Modell TS-405 med H2231 Drivmotor (220-240 V), Varens opprinnelsesland:Japan  
Borstativ Modell TS-405(AB61) med H2231 Drivmotor (220-240 V), Varens opprinnelsesland:Japan

Serienummer:

Nevnt i denne erklæring i samsvar med følgende direktiv(er)

Maskin direktiv **2006/42/EC**, Annex I, Annex IIA

Harmonisert standard: EN 62841-1:2015, EN 62841-3-6:2014  
EN ISO 12100:2010

EMC Direktiv **2014/30/EU**

Harmonisert standard: EN 55014-1:2006+A1:2009+A2:2011, EN 55014-2:1997+A1:2001+A2:2008  
EN 61000-3-2:2014, EN 61000-3-3:2013, EN 61000-3-11:2000

RoHS Direktiv **2011/65/EU**

Importør i Norge

SVERRE HELLUM & SØNN AS  
LINDEBERG NAERINGSVEI 28, 1067 OSLO  
NORWAY  
MR. GLENN HELLUM  
TEL : +47 23 17 81 00

Tekniskansvarlig for utforming av de tekniskefilene;  
J.D. DIAMOND TOOLS A/S  
GLENTEVEJ 33, DK-4600 KOGE, DENMARK

Merk: Denne deklarasjonen blir ugyldig om tekniske eller operasjonelle modifikasjoner blir utført uten produsentens tillatelse

Hiroshima, 11/2022  
Kazuyoshi Shibuya, President & CEO  
SHIBUYA COMPANY, LTD.

## ES ATITIKTIES DEKLARACIJA

SHIBUYA COMPANY, LTD.  
5-86, MOKUZAIKO-KITA, HATSUKAICHI, HIROSHIMA 738-0021 JAPONIJA  
Deklaruoja, kad sekantys gaminiai:

Gręžimo stovo modelis TS-405 su H2231 gręžimo varikliu (220-240 V), Kilmės šalis: Japonija  
Gręžimo stovo modelis TS-405(AB61) su H2231 gręžimo varikliu (220-240 V), Kilmės šalis: Japonija

Serijos Nr.:

Atitinka sekančias direktyvas:

Mašinų direktyva **2006/42/EC**, Annex I, Annex IIA

Atitinka standartus: EN 62841-1:2015, EN 62841-3-6:2014  
EN ISO 12100:2010

Elektromagnetinio suderinamumo direktyva **2014/30/EU**

Atitinka standartus: EN 55014-1:2006+A1:2009+A2:2011, EN 55014-2:1997+A1:2001+A2:2008  
EN 61000-3-2:2014, EN 61000-3-3:2013, EN 61000-3-11:2000

RoHS direktyva **2011/65/EU**

Autorizuotas atstovas / Importuotojas Lietuvoje;

MONTEZA UAB  
Pranciškonų 4A-23, Lt-01133 Vilnius, Lietuva

Asmuo įgaliotas parengti techninę dokumentaciją;  
Andrius Montvydas  
Pranciškonų 4A-23, Lt-01133 Vilnius, Lietuva

Pastaba: ši deklaracija tampa negaliojanti jei techninės modifikacijos buvo atliktos be gamintojo sutikimo.

Hiroshima, 7/2021  
Kazuyoshi Shibuya, Direktorius  
SHIBUYA COMPANY, LTD.

## UK DECLARATION OF CONFORMITY

SHIBUYA COMPANY, LTD.

5-86, MOKUZAIKO-KITA, HATSUKAICHI, HIROSHIMA 738-0021 JAPAN

declares, in sole responsibility, that the following equipment

Drill Stand Model TS-405 with H2231 Drill Motor (110 V), Country of Origin: Japan

Drill Stand Model TS-405(AB61) with H2231 Drill Motor (110 V), Country of Origin: Japan

Serial No.: 2240001 - UP

referred to in this declaration conforms with the following regulation (s):

The Supply of Machinery (Safety) Regulations 2008

Harmonized standards: EN 62841-1:2015, EN 62841-3-6:2014

EN ISO 12100:2010

The Electromagnetic Compatibility Regulations 2016

Harmonized standards: EN 55014-1:2006+A1:2009+A2:2011, EN 55014-2:1997+A1:2001+A2:2008

EN 61000-3-2:2014, EN 61000-3-3:2013, EN 61000-3-11:2000

The Restriction of the Use of Certain Hazardous Substances

in Electrical and Electronic Equipment Regulations 2012

Authorized representative / Importer in UK;

GILES ENGINEERING (UK) LTD

Unit 6 Cathcart Court, 50 Cathcart Road, Rutherglen, South Lanarkshire G73 2RA,  
Scotland, United Kingdom

Mr. Derek Cummings

The person authorized to compile the technical file;

Mr. Derek Cummings

Unit 6 Cathcart Court, 50 Cathcart Road, Rutherglen, South Lanarkshire G73 2RA,  
Scotland, United Kingdom

Note: This declaration becomes invalid if technical or operational modifications are introduced without the manufacturer's consent.

Hiroshima, 2/2023

Kazuyoshi Shibuya, President & CEO

SHIBUYA COMPANY, LTD.



## ESB-SAMRÆMISYFIRLÝSING

SHIBUYA COMPANY, LTD.

5-86, MOKUZAIKO-KITA, HATSUKAICHI, HIROSHIMA 738-0021 JAPAN

lýsir því yfir, á eigin ábyrgð, að eftirfarandi búnaður

Drill Stand Model (borstandur módel) TS-405 með H2231 Drill Motor (borvél) (220-240 V), Upprunaland: Japan  
Drill Stand Model (borstandur módel) TS-405(AB61) með H2231 Drill Motor (borvél) (220-240 V) , Upprunaland: Japan

Raðnúmer.: 1960001 – UP

sem vísað er til í þessari yfirlýsingu, samræmist eftirfarandi tilskipunum::

Vélatilskipun **2006/42/EB**, viðauki I, viðauki IIA

Samhæfðir staðlar: EN 62841-1:2015, EN 62841-3-6:2014

EN ISO 12100:2010

EMC-tilskipun **2014/30/ESB**

Samhæfðir staðlar: EN 55014-1:2006+A1:2009+A2:2011, EN 55014-2:1997+A1:2001+A2:2008

EN 61000-3-2:2014, EN 61000-3-3:2013, EN 61000-3-11:2000

RoHS-tilskipun **2011/65/ESB**

Innflytjandi á Íslandi;

DIAPRO EHF

BUGÐUFLJÓT 17A, MOSFELLSBÆR 270, ÍSLAND

Aðili með heimild til samantektar tækniskjals;

HR. HANS HENRIK DAMIELSEN

J.D. DIAMOND TOOLS A/S

GLENTEVEJ 33, DK-4600 KOGE, DANMÖRK

Ath.: Þessi yfirlýsing verður ógild ef tæknilegar breytingar eru gerðar án samþykkis framleiðanda.

Hiroshima, 1/2024

Kazuyoshi Shibuya, forseti og forstjóri

SHIBUYA COMPANY, LTD.

## UK DECLARATION OF CONFORMITY

SHIBUYA COMPANY, LTD.  
5-86, MOKUZAIKO-KITA, HATSUKAICHI, HIROSHIMA 738-0021 JAPAN  
declares, in sole responsibility, that the following equipment

Drill Stand Model TS-405 with H2231 Drill Motor (110 V), Country of Origin: Japan  
Drill Stand Model TS-405(AB61) with H2231 Drill Motor (110 V), Country of Origin: Japan

Serial No.: 2240001 - UP

referred to in this declaration conforms with the following regulation (s):

The Supply of Machinery (Safety) Regulations 2008

Harmonized standards: EN 62841-1:2015, EN 62841-3-6:2014

EN ISO 12100:2010

The Electromagnetic Compatibility Regulations 2016

Harmonized standards: EN 55014-1:2006+A1:2009+A2:2011, EN 55014-2:1997+A1:2001+A2:2008

EN 61000-3-2:2014, EN 61000-3-3:2013, EN 61000-3-11:2000

The Restriction of the Use of Certain Hazardous Substances

in Electrical and Electronic Equipment Regulations 2012

Authorized representative / Importer in Ireland;

Erlin Business Company Ltd T/A Concrete Care  
Staybarr House Kylemore Park North  
Dublin 10, Ireland

The person authorized to compile the technical file;

Mr. Romas Petrovas  
Staybarr House Kylemore Park North  
Dublin 10, Ireland

Note: This declaration becomes invalid if technical or operational modifications are introduced without the manufacturer's consent.

Hiroshima, 6/2024  
Kazuyoshi Shibuya, President & CEO  
SHIBUYA COMPANY, LTD.

## ΔΗΛΩΣΗ ΣΥΜΜΟΡΦΩΣΗΣ ΕΕ

SHIBUYA COMPANY, LTD.  
5-86, MOKUZAIKO-KITA, HATSUKAICHI, HIROSHIMA 738-0021 JAPAN  
δηλώνει, με αποκλειστική ευθύνη, ότι ο ακόλουθος εξοπλισμός

Μονάδα διαμαντοτρίπανου με βάση TS-405 και Κινητήρα H2231 (220-240 V), Χώρα Προέλευσης: Ιαπωνία  
Μονάδα διαμαντοτρίπανου με βάση TS-405(AB61) και Κινητήρα H2231 (220-240 V), Χώρα Προέλευσης: Ιαπωνία

Σειριακός αριθμός: 1960001 – UP

που αναφέρεται σε αυτή τη δήλωση συμμορφώνεται με τις ακόλουθες οδηγίες:

Οδηγία Μηχανών **2006/42/ΕΚ**, Παράρτημα I, Παράρτημα IIA

Πρότυπα εναρμόνισης: EN 62841-1:2015, EN 62841-3-6:2014  
EN ISO 12100:2010

Οδηγία EMC **2014/30/ΕΕ**

Πρότυπα εναρμόνισης: EN 55014-1:2006+A1:2009+A2:2011, EN 55014-2:1997+A1:2001+A2:2008  
EN 61000-3-2:2014, EN 61000-3-3:2013, EN 61000-3-11:2000

Οδηγία RoHS **2011/65/ΕΕ**

Εισαγωγέας στην Ελληνική Δημοκρατία:

SARRIS MACHINERY SA  
Paragianni Skoula and Irakli, 71305 Heraklion Crete, Greece

Το άτομο που έχει εξουσιοδοτηθεί να συντάξει τον τεχνικό φάκελο:

Mr. Theodoros Sarris  
Paragianni Skoula and Irakli, 71305 Heraklion Crete, Greece

Σημείωση: Αυτή η δήλωση καθίσταται άκυρη εάν εισαχθούν τεχνικές ή λειτουργικές τροποποιήσεις χωρίς τη συγκατάθεση του κατασκευαστή.

Hiroshima, 6/2024

Kazuyoshi Shibuya, Πρόεδρος και Διευθύνων Σύμβουλος  
SHIBUYA COMPANY, LTD.

**SHIBUYA**